

72nd Station

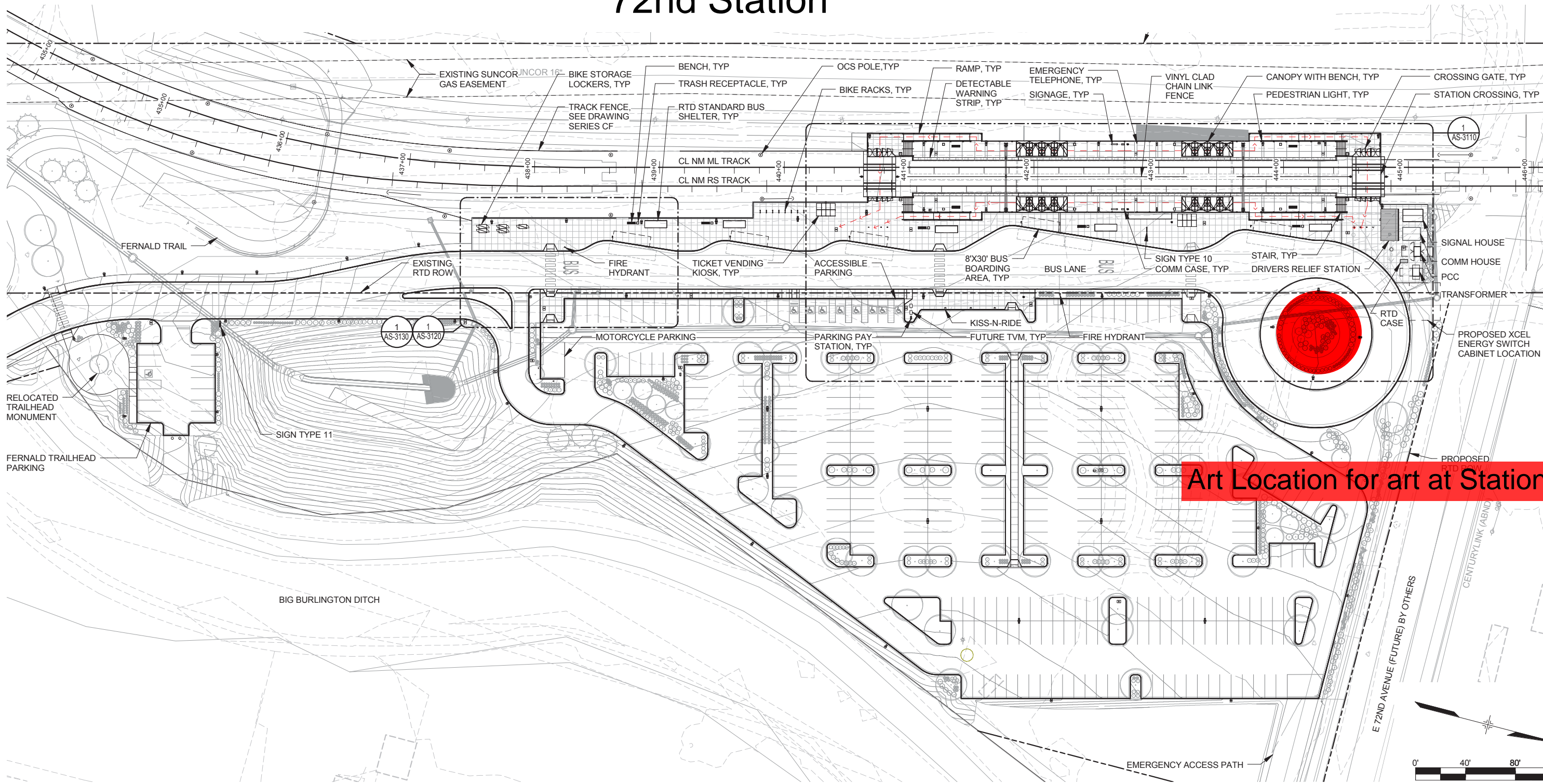

Art Location for art at Station

1 SITE PLAN

RFC
Twine
03-039.12A.06
11/23/2016

NOTES:

1. FOR STATION SPECIFIC STRUCTURAL DETAILS, SEE DRAWING SERIES SS-3000
2. FOR STATION SPECIFIC MECHANICAL DETAILS, SEE DRAWING SERIES MS-3000
3. FOR STATION SPECIFIC PLUMBING DETAILS, SEE DRAWING SERIES PS-3000
4. FOR STATION SPECIFIC ELECTRICAL DETAILS, SEE DRAWING SERIES ES-3000
5. FOR STATION SPECIFIC CIVIL DETAILS, SEE DRAWING SERIES CS-3000
6. FOR STATION SPECIFIC GRADING DETAILS, SEE DRAWING SERIES DJ-3000
7. FOR STATION SPECIFIC UTILITY DETAILS, SEE DRAWING SERIES UB-3000
8. FOR STATION SPECIFIC LANDSCAPE DETAILS, SEE DRAWING SERIES LS-3000

LEGEND
→ ACCESSIBLE PATH OF TRAVEL



NO.	REVISIONS	BY	DATE
0	ISSUED FOR CONSTRUCTION	VAM	09/16/2016

DESIGNED BY: MBB DATE: 07/28/2014
DRAWN BY: TJG DATE: 07/28/2014

R-P
REGIONAL RAIL PARTNERS
A Balfour Beatty / GRAHAM JOINT VENTURE

CHECKED BY: TLB DATE: 09/14/2016
APPROVED BY: VAM DATE: 09/14/2016

IRON HORSE
ARCHITECTS
RESPONSIBLE DESIGN
475 17th Street Suite 720
Denver, Colorado 80202
iron-horse-architects.com

RTD FasTracks
North Metro
Rail Line
REGIONAL TRANSPORTATION DISTRICT
1600 BLAKE STREET
DENVER, COLORADO 80202
(303) 628-9000

NORTH METRO RAIL LINE
ARCHITECTURAL
COMMERCE CITY AT 72ND AVE STATION
SITE PLAN

DWG No. AS-3101