



IGA with RTD for Public Art at NRML Station

.....●
●.....

March 2, 2020

Background

- Agreement with RTD to fund public art at NMRL station
- Total cost to city: \$22,000
 - RTD contributes \$44,000
- Cultural Council selects art pieces
- Art installed in station and on power control and signal cabinets
- RTD owns art and is responsible for maintenance



Public Art Benefits

- Celebrates community
- Creates sense of place
- Deters vandalism
- Increases visitors



Commerce
CITY

Selection Process

- Overseen by Cultural Council with RTD input
- Develop criteria for artwork
 - Medium, style, open call, purchase of existing art
- Issue Call to Artists based on criteria
- Artists apply/make presentations
- Artists are selected
 - Approved by Cultural Council and City Council

Location of Wraps

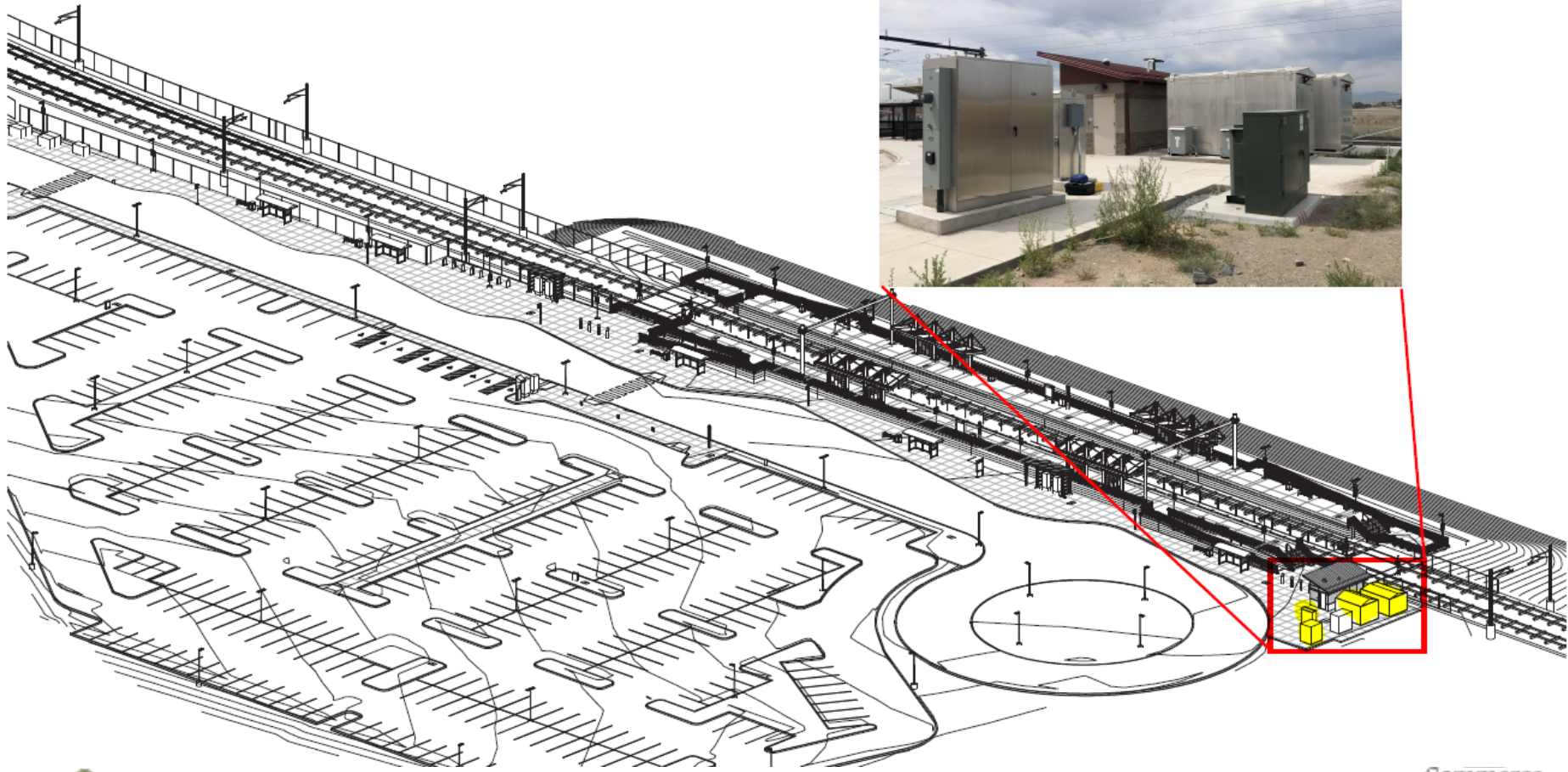

Resolution for Council Consideration

- The Resolution, if passed by the City Council, authorizes the Mayor to sign the IGA



Commerce
CITY