



Job No.: 65319752-02  
File: SDI-0229 (220,331) ACCESS.docx  
Date: March 2, 2021

**EXHIBIT B**  
**PROPERTY DESCRIPTION**

PARCEL SDI-0229

City of Commerce City, A Municipal Corporation

**PARCEL A:**

A Permanent Access Easement being a portion of a parcel of land described in Special Warranty Deed recorded May 27, 2005 at Reception No. 20050527000564980 in the Adams County Clerk and Recorder's Office, being in a portion of the Northwest Quarter of Section 6, Township 2 South, Range 66 West of the 6th Principal Meridian, County of Adams, State of Colorado, being more particularly described as follows:

**COMMENCING** at the West Quarter corner of said Section 6, whence the Northwest corner of said Section 6 bears N00°30'28"W a distance of 2,652.19 feet;  
THENCE N88°22'07"E along the southerly line of said Northwest Quarter of Section 6 a distance of 1,393.92 feet to the **POINT OF BEGINNING PARCEL A;**

THENCE N54°51'25"E a distance of 190.52 feet;  
THENCE N74°35'25"E a distance of 83.47 feet;  
THENCE S20°24'55"E along an easterly line of a proposed sanitary sewer easement a distance of 20.08 feet;  
THENCE S74°35'25"W a distance of 81.74 feet;  
THENCE S54°50'20"W a distance of 156.77 feet;  
THENCE S88°22'07"W along said southerly line of the Northwest Quarter of Section 6 a distance of 36.32 feet to the **POINT OF BEGINNING PARCEL A.**

Containing 5,130 net square feet (0.118 Acres), more or less.

**TOGETHER WITH PARCEL B:**

Jacob Stone Frisch, PLS 38149  
Date: March 2, 2021  
Job No.: 65319752-02  
For and on Behalf of  
Merrick & Company



A Permanent Access Easement being a portion of TRACT M, BUFFALO MESA SUBDIVISION FILING NO. 1 according to the plat thereof recorded February 12, 2003 at Reception No. C1094594 in File 18, Map 849 of the Adams County Clerk and Recorder's Office, being in a portion of the Southwest Quarter of Section 8, Township 2 South, Range 66 West of the 6<sup>th</sup> Principle Meridian, County of Adams, State of Colorado being more particularly described as follows:

**COMMENCING** at the South Quarter Corner of said Section 8, whence the Southwest Corner of said Section 8 bears S89°19'37"W a distance of 2,653.92 feet;  
THENCE N71°57'55"W a distance of 1,244.72 feet to the **POINT OF BEGINNING PARCEL B;**

THENCE S13°40'53"E along the westerly line of a proposed sanitary sewer easement, non-tangent with the following described curve a distance of 36.34 feet;

THENCE along the arc of a curve to the left, having a central angle of 76°30'08", a radius of 20.00 feet, a chord bearing N51°55'57"W a distance of 24.76 feet, and an arc distance of 26.70 feet;

THENCE S89°48'59"W tangent with the last and following described curves a distance of 190.55 feet;

THENCE along the arc of a curve to the left, having a central angle of 48°35'50", a radius of 30.00 feet, a chord bearing S65°31'04"W a distance of 24.69 feet, and an arc distance of 25.45 feet;

THENCE S41°13'09"W tangent with the last described curve a distance of 12.43 feet;

THENCE S88°32'34"W along a southerly line of said TRACT M a distance of 27.20 feet;

THENCE N41°13'09"E tangent with the following described curve a distance of 30.87 feet;

THENCE along the arc of a curve to the right, having a central angle of 48°35'50", a radius of 50.00 feet, a chord bearing N65°31'04"E a distance of 41.15 feet, and an arc distance of 42.41 feet;

THENCE N89°48'59"E tangent with the last described curve a distance of 201.52 feet to the **POINT OF BEGINNING PARCEL B.**

Containing 5,238 net square feet (0.120 Acres), more or less.

**TOGETHER WITH PARCEL C:**

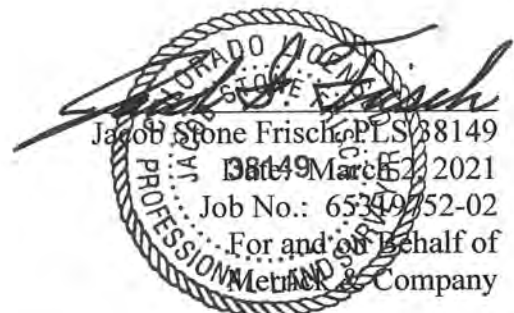

A Permanent Access Easement being a portion of TRACT M, BUFFALO MESA SUBDIVISION FILING NO. 1 according to the plat thereof recorded February 12, 2003 at Reception No. C1094594 in File 18, Map 849 of the Adams County Clerk and Recorder's Office, being in a portion of the Southwest Quarter of Section 8, Township 2 South, Range 66 West of the 6<sup>th</sup> Principle Meridian, County of Adams, State of Colorado being more particularly described as follows:

**COMMENCING** at said South Quarter Corner of said Section 8;  
THENCE N79°01'43"W a distance of 371.59 feet to the **POINT OF BEGINNING**  
**PARCEL C;**

THENCE S89°19'37"W along a southerly most line of said TRACT M a distance of 20.87 feet;

THENCE N17°15'18"W a distance of 130.19 feet;

THENCE N04°27'27"E tangent with the following described curve a distance of 77.31 feet;

THENCE along the arc of a curve to the left, having a central angle of 98°17'49", a radius of 30.00 feet, a chord bearing N44°41'27"W a distance of 45.38 feet, and an arc distance of 51.47 feet;

THENCE S86°09'38"W tangent with the last and following described curves a distance of 187.13 feet;

THENCE along the arc of a curve to the right, having a central angle of 70°02'59", a radius of 230.00 feet, a chord bearing N58°48'52"W a distance of 264.01 feet, and an arc distance of 281.20 feet;

THENCE N23°47'23"W tangent with the last and following described curves a distance of 114.06 feet;

THENCE along the arc of a curve to the left, having a central angle of 76°41'36", a radius of 225.00 feet, a chord bearing N62°08'11"W a distance of 279.19 feet, and an arc distance of 301.17 feet;

THENCE S79°31'02"W tangent with the last described curve a distance of 52.98 feet;

THENCE N13°40'53"W along the easterly line of said proposed sanitary sewer easement a distance of 20.03 feet;

THENCE N79°31'02"E tangent with the following described curve a distance of 54.09 feet;

THENCE along the arc of a curve to the right, having a central angle of 76°41'36", a radius of 245.00 feet, a chord bearing S62°08'11"E a distance of 304.00 feet, and an arc distance of 327.94 feet;

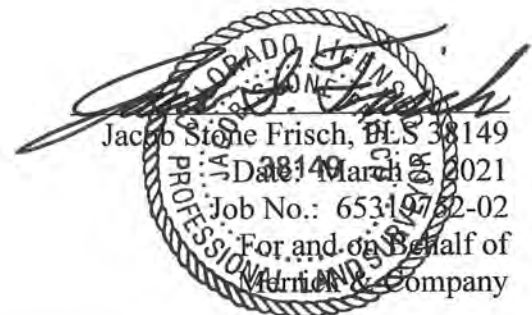

Jacob Stone Frisch, BLS 38149  
Date: March 5, 2021  
Job No.: 65319752-02  
For and on Behalf of  
Merrick & Company

THENCE S23°47'23"E tangent with the last and following described curves a distance of 114.06 feet;  
THENCE along the arc of a curve to the left, having a central angle of 70°02'59", a radius of 210.00 feet, a chord bearing S58°48'52"E a distance of 241.05 feet, and an arc distance of 256.75 feet;  
THENCE N86°09'38"E tangent with the last and following described curves a distance of 187.13 feet;  
THENCE along the arc of a curve to the right, having a central angle of 98°17'49", a radius of 50.00 feet, a chord bearing S44°41'27"E a distance of 75.64 feet, and an arc distance of 85.78 feet;  
THENCE S04°27'27"W tangent with the last described curve a distance of 73.47 feet;  
THENCE S17°15'18"E a distance of 132.31 feet to the **POINT OF BEGINNING PARCEL C.**

Containing 24,271 net square feet (0.557 Acres), more or less.

Containing 34,639 gross square feet (0.795 Acres), more or less.



Jacob Stone Frisch, P.L.S. 38149  
Date: March 2, 2021  
Job No.: 65319752-02  
For and on Behalf of:  
Merrick & Company

S89°29'44"W 2674.84'

T1S  
T2S

NW COR. SEC. 6,  
T2S, R66WFND 2-1/2"  
DIA. ALUM. CAP,  
STAMPED "ZBS INC.,  
2006, LS 29028", 0.1'  
BELOW GND IN A RANGE  
BOX FLUSH W/ROAD

N 1/4 COR. OF SEC. 6, T2S, R66W  
FND 3-1/4" DIA. ALUM. CAP, STAMPED  
"POINT #137, ROW MONUMENT 176, ROW PROJ  
MB076, DEPT OF TRANSPORTATION, PLS NO  
29039", 0.7' BELOW GND  
IN RANGE BOX FLUSH W/THE ROAD

BASIS OF BEARINGS:

N00°30'28"W 2652.19'

EASTERLY LINE OF  
BNSF RAILROAD  
RIGHT OF WAY

NW1/4  
SECTION 6,  
T2S, R66W

BNSF RAILROAD (200' ROW)

PROPOSED SANITARY EASEMENT

30' WIDE EXCLUSIVE SANITARY SEWER  
EASEMENT FOR CITY OF COMMERCE CITY  
NORTHERN INFRASTRUCTURE GENERAL  
IMPROVEMENT DISTRICT, RECEPTION NUMBER  
C0607086, BOOK 5936 PAGE 7, DATED  
10/29/1999

Parcel A Line Table

Line #	Direction	Length
L1	N54° 51' 25"E	190.52
L2	N74° 35' 25"E	83.47
L3	S20° 24' 55"E	20.08
L4	S74° 35' 25"W	81.74
L5	S54° 50' 20"W	156.77
L6	S88° 22' 07"W	36.32

POINT OF  
BEGINNING  
PARCEL A

PARCEL A  
CITY OF COMMERCE CITY,  
A MUNICIPAL CORPORATION  
AREA=5,130 SQ FT  
(0.118 ACRES) ±

C 1/4 OF SEC. 6, T2S, R66W  
FND #6 REBAR W/ 3-1/4" DIA.  
ALUM. CAP, STAMPED "R.W. BAYER  
ASSOC., 1998, PLS 6973",  
FLUSH WITH THE GND

R67W  
R66W

1393.92'

N88°22'07"E 2653.41'

POINT OF COMMENCEMENT

W 1/4 COR. SEC. 1, T2S, R66W  
FND #6 REBAR W/  
3-1/4" DIA. ALUM. CAP,  
STAMPED "2002, PLS 29039",  
FLUSH

SW1/4  
SECTION 6,  
T2S, R66W

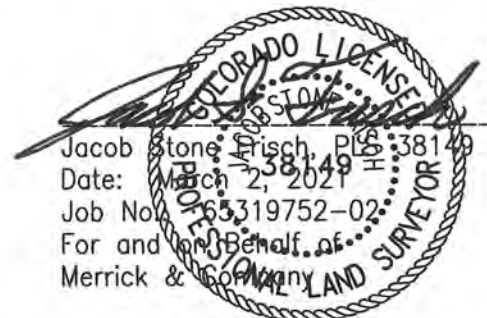

NOTE

This exhibit does not represent a monumented survey. It is intended only to depict the attached description.

Dwg. CWS

Ckd. JSF

App. JSF



METRO WASTEWATER  
RECLAMATION DISTRICT

EXHIBIT B

Parcel SDI-0229 Access

Second Creek Interceptor

DATE:  
03/2/2021

DWG. NO.  
SDI-0229

SH 5 OF 8

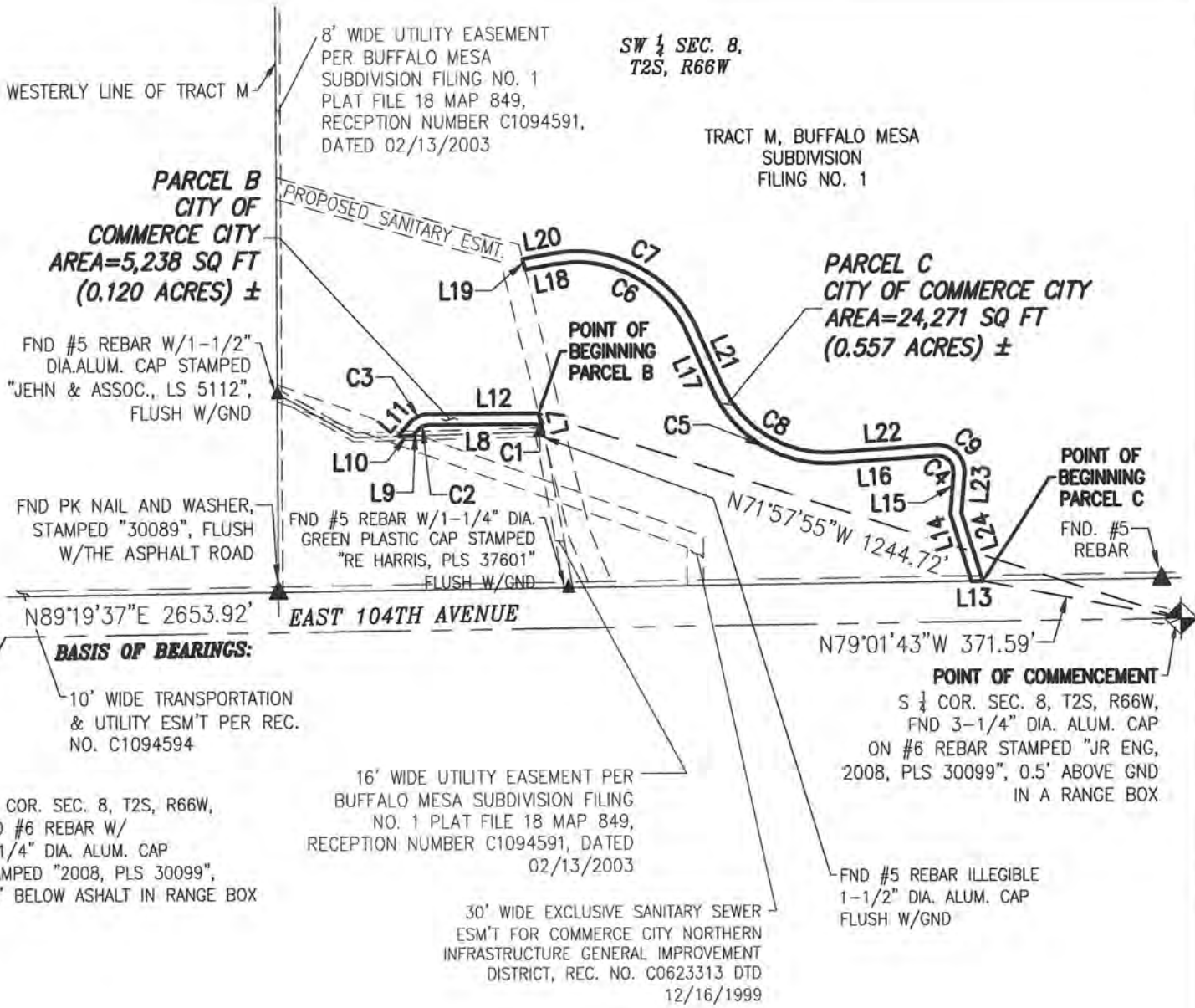

**BASIS OF BEARINGS:**

SW COR. SEC. 8, T2S, R66W, FND #6 REBAR W/ 3-1/4" DIA. ALUM. CAP STAMPED "2008, PLS 30099", 0.5' BELOW ASHALT IN RANGE BOX

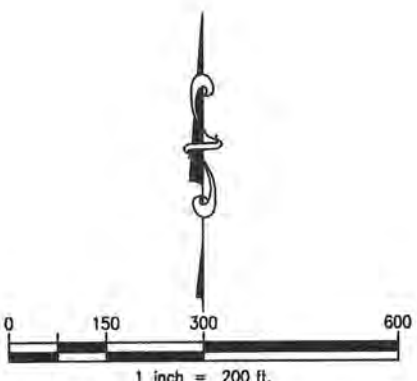

**NOTE**  
This exhibit does not represent a monumented survey. It is intended only to depict the attached description.

Jacob Stone Frisch, PLS 38149  
 Date: March 2, 2021  
 Job No: 65319752-02  
 For and on behalf of Merrick & Company

Dwg. CWS  
 Ckd. JSF  
 App. JSF

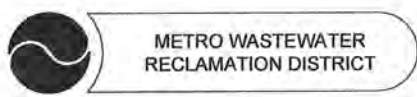

**EXHIBIT B**  
 Parcel SDI-0229 Access  
 Second Creek Interceptor

DATE: 03/2/2021  
 DWG. NO. SDI-0229  
 SH 6 OF 8

# PARCEL B

CURVE TABLE					
CURVE #	DELTA	RADIUS	CHORD BEARING	CHORD LENGTH	LENGTH
C1	76° 30' 08"	20.00'	N51° 55' 57"W	24.76'	26.70'
C2	48° 35' 50"	30.00'	S65° 31' 04"W	24.69'	25.45'
C3	48° 35' 50"	50.00'	N65° 31' 04"E	41.15'	42.41'

Parcel Line Table		
Line #	Direction	Length
L7	S13° 40' 53"E	36.34
L8	S89° 48' 59"W	190.55
L9	S41° 13' 09"W	12.43
L10	S88° 32' 34"W	27.20
L11	N41° 13' 09"E	30.87
L12	N89° 48' 59"E	201.52

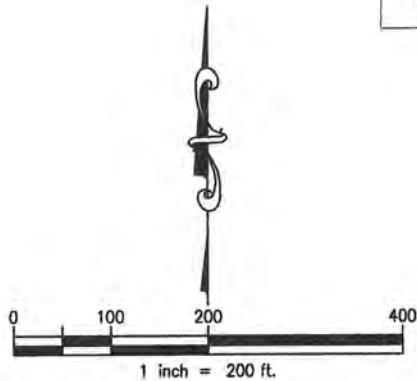

Jacob Stone Frisch, PLS 38149  
 Date: March 2, 2021  
 Job No. 65319752-02  
 For and on Behalf of  
 Merrick & Company

**NOTE**

This exhibit does not represent a monumented survey. It is intended only to depict the attached description.

Dwg.     CWS      
 Ckd.     JSF      
 App.     JSF    

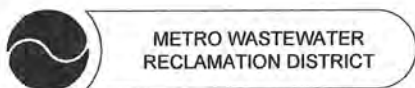

METRO WASTEWATER  
RECLAMATION DISTRICT

**EXHIBIT B**  
 Parcel SDI-0229 Access  
 Second Creek Interceptor

DATE:  
 03/2/2021  
 DWG. NO.  
 SDI-0229  
 SH 7 OF 8

# PARCEL C

CURVE TABLE					
CURVE #	DELTA	RADIUS	CHORD BEARING	CHORD LENGTH	LENGTH
C4	98° 17' 49"	30.00'	N44° 41' 27"W	45.38'	51.47'
C5	70° 02' 59"	230.00'	N58° 48' 52"W	264.01'	281.20'
C6	76° 41' 36"	225.00'	N62° 08' 11"W	279.19'	301.17'
C7	76° 41' 36"	245.00'	S62° 08' 11"E	304.00'	327.94'
C8	70° 02' 59"	210.00'	S58° 48' 52"E	241.05'	256.75'
C9	98° 17' 49"	50.00'	S44° 41' 27"E	75.64'	85.78'

Parcel Line Table		
Line #	Direction	Length
L13	S89° 19' 37"W	20.87
L14	N17° 15' 18"W	130.19
L15	N4° 27' 27"E	77.31
L16	S86° 09' 38"W	187.13
L17	N23° 47' 23"W	114.06
L18	S79° 31' 02"W	52.98
L19	N13° 40' 53"W	20.03
L20	N79° 31' 02"E	54.09
L21	S23° 47' 23"E	114.06
L22	N86° 09' 38"E	187.13
L23	S4° 27' 27"W	73.47
L24	S17° 15' 18"E	132.31

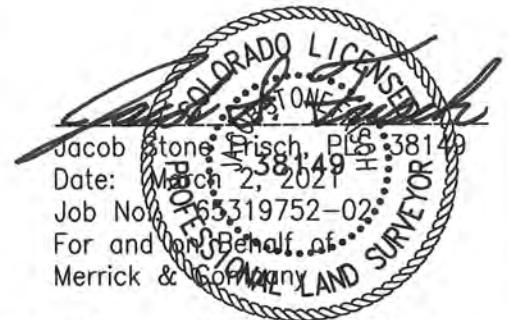
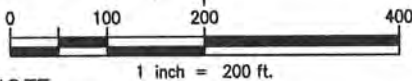

**NOTE**

This exhibit does not represent a monumented survey. It is intended only to depict the attached description.

Dwg. <u>    CWS    </u>	 <p>METRO WASTEWATER RECLAMATION DISTRICT</p>	<p><b>EXHIBIT B</b></p> <p>Parcel SDI-0229 Access</p> <p>Second Creek Interceptor</p>	DATE: 03/2/2021
Ckd. <u>    JSF    </u>			DWG. NO. SDI-0229
App. <u>    JSF    </u>			SH 8 OF 8





Job No.: 65319752-02  
File: SDI-0229 (230,331) ACCESS.docx  
Date: March 2, 2021

**EXHIBIT B**  
**PROPERTY DESCRIPTION**  
**PARCEL SDI-0229 ACCESS**  
City of Commerce City, Colorado

Permanent Access Easements being a portion of a parcel of land described in Warranty Deed recorded April 10, 2013 at Reception No. 20130000300006 in the Adams County Clerk and Recorder's Office, being in a portion of the Southwest Quarter of Section 6, Township 2 South, Range 66 West of the 6th Principal Meridian, County of Adams, State of Colorado, being more particularly described as follows:

**ACCESS A:**

**COMMENCING** at the northeast corner of said Southwest Quarter of Section 6, whence the Northwest corner of said Southwest Quarter of Section 6 bears S88°22'07"W a distance of 2,653.41 feet;

THENCE S88°22'07"W along the northerly line of said Southwest Quarter of Section 6 a distance of 1,223.18 feet to the **POINT OF BEGINNING ACCESS A;**

THENCE S54°50'20"W a distance of 27.84 feet;

THENCE S41°28'51"W tangent with the following described curve a distance of 9.23 feet;

THENCE along the arc of a curve to the left, having a central angle of 103°14'18", a radius of 20.00 feet, a chord bearing S10°08'18"E a distance of 31.36 feet, and an arc distance of 36.04 feet;

THENCE S61°45'27"E tangent with the last described curve, non-tangent with the following described curve a distance of 17.33 feet;

THENCE along the arc of a curve to the right, having a central angle of 34°39'11", a radius of 155.76 feet, a chord bearing S43°21'00"E a distance of 92.78 feet, and an arc distance of 94.21 feet;

THENCE S26°01'15"E tangent with the last described curve a distance of 47.03 feet;

THENCE S28°10'37"E a distance of 91.75 feet;

THENCE S33°31'38"E a distance of 71.32 feet;

THENCE S23°44'01"E a distance of 49.92 feet;

THENCE S10°05'43"E a distance of 172.96 feet;

THENCE S12°00'17"E tangent with the following described curve a distance of 154.19 feet;

Jacob Stone Frisch, PL 38149  
Date: March 2, 2021  
Job No.: 65319752-02  
For and on Behalf of  
Merrick & Company



THENCE along the arc of a curve to the left, having a central angle of 26°11'35", a radius of 326.00 feet, a chord bearing S25°06'04"E a distance of 147.74 feet, and an arc distance of 149.03 feet;  
THENCE S28°11'28"W non-tangent with the last described curve, along a westerly line of a proposed sanitary sewer easement, tangent with the following described curve a distance of 47.56 feet;

THENCE along the arc of a curve to the left, having a central angle of 63°46'30", a radius of 40.00 feet, a chord bearing N03°41'47"W a distance of 42.26 feet, and an arc distance of 44.52 feet;  
THENCE along the arc of a curve to the right, having a central angle of 03°14'05", a radius of 346.00 feet, a chord bearing N33°58'00"W a distance of 19.53 feet, and an arc distance of 19.53 feet;

THENCE the following two (2) courses along the westerly lines of said parcel of land described in Reception No. 20130000300006:

1. N05°56'19"E non-tangent with the last described curve a distance of 28.55 feet;
2. THENCE N25°47'18"W a distance of 127.51 feet;

THENCE N12°00'17"W a distance of 123.82 feet;

THENCE N10°05'43"W a distance of 170.90 feet;

THENCE N23°44'01"W a distance of 45.81 feet;

THENCE N33°31'38"W a distance of 70.54 feet;

THENCE N28°10'37"W a distance of 93.07 feet;

THENCE N26°01'15"W tangent with the following described curve a distance of 47.41 feet;

THENCE along the arc of a curve to the left, having a central angle of 34°39'31", a radius of 135.74 feet, a chord bearing N43°21'01"W a distance of 80.86 feet, and an arc distance of 82.11 feet;

THENCE N61°45'27"W non-tangent with the last described curve, tangent with the following described curve a distance of 23.12 feet;

THENCE along the arc of a curve to the left, having a central angle of 56°58'31", a radius of 30.00 feet, a chord bearing S89°45'18"W a distance of 28.62 feet, and an arc distance of 29.83 feet;

THENCE the following three (3) course along the westerly and northerly lines of parcel of land described in Reception No. 20130000300006:

1. N25°47'18"W non-tangent with the last described curve a distance of 23.63 feet;
2. THENCE N41°24'24"E a distance of 61.76 feet;
3. THENCE N88°22'07"E along said northerly line of the Southwest Quarter of Section 6 a distance of 36.32 feet to the **POINT OF BEGINNING ACCESS A.**

Containing 17,717 net square feet (0.407 Acres), more or less.

**TOGETHER WITH ACCESS B:**





**COMMENCING** at said northeast corner of the Southwest Quarter of Section 6;  
THENCE S45°21'26"W a distance of 1,251.09 feet to the **POINT OF BEGINNING ACCESS B**;

THENCE along the arc of a curve to the left, having a central angle of 04°47'39", a radius of 326.00 feet, a chord bearing S48°04'31"E a distance of 27.27 feet, and an arc distance of 27.28 feet;  
THENCE S50°28'20"E tangent with the last and following described curves a distance of 428.81 feet;

THENCE along the arc of a curve to the right, having a central angle of 67°59'26", a radius of 56.00 feet, a chord bearing S16°28'37"E a distance of 62.62 feet, and an arc distance of 66.45 feet;  
THENCE S17°31'06"W tangent with the last and following described curves a distance of 236.32 feet;

THENCE along the arc of a curve to the right, having a central angle of 29°50'24", a radius of 46.00 feet, a chord bearing S32°26'18"W a distance of 23.69 feet, and an arc distance of 23.96 feet;  
THENCE S47°21'30"W tangent with the last described curve a distance of 51.81 feet;  
THENCE N24°25'30"W along an easterly line of said proposed sanitary sewer easement a distance of 21.06 feet;

THENCE N47°21'30"E tangent with the following described curve a distance of 42.03 feet;  
THENCE along the arc of a curve to the left, having a central angle of 29°50'24", a radius of 38.00 feet, a chord bearing N32°26'18"E a distance of 19.57 feet, and an arc distance of 19.79 feet;  
THENCE N17°31'06"E tangent with the last and following described curves a distance of 233.12 feet;

THENCE along the arc of a curve to the left, having a central angle of 67°59'26", a radius of 36.00 feet, a chord bearing N16°28'37"W a distance of 40.26 feet, and an arc distance of 42.72 feet;  
THENCE N50°28'20"W tangent with the last described curve a distance of 428.81 feet;  
THENCE along the arc of a curve to the right, having a central angle of 03°50'19", a radius of 346.00 feet, a chord bearing N48°33'11"W a distance of 23.18 feet, and an arc distance of 23.18 feet;

THENCE N28°11'28"E non-tangent with the last described curve, along a southerly line of said proposed sanitary sewer easement a distance of 20.77 feet to the **POINT OF BEGINNING ACCESS B**.

Containing 16,249 net square feet (0.373 Acres), more or less.

**TOGETHER WITH ACCESS C:**

**COMMENCING** at the southeast corner of said Southwest Quarter of Section 6, whence the West Sixteenth corner of Sections 6 and 7 of said Section 6 bears S88°21'17"W a distance of 1,318.09 feet;





THENCE N88°36'32"W a distance of 566.40 feet to the **POINT OF BEGINNING ACCESS C**;  
THENCE S88°21'17"W along the southerly line of said parcel of land described in Reception No. 20130000300006, said line being 30.00 feet northerly of and parallel with the southerly line of said Southwest Quarter of Section 6 a distance of 20.45 feet;

THENCE N13°44'34"W tangent with the following described curve a distance of 14.72 feet;  
THENCE along the arc of a curve to the left, having a central angle of 70°23'05", a radius of 26.00 feet, a chord bearing N48°56'06"W a distance of 29.97 feet, and an arc distance of 31.94 feet;  
THENCE N84°07'39"W tangent with the last and following described curves a distance of 218.95 feet;

THENCE along the arc of a curve to the right, having a central angle of 18°59'51", a radius of 46.00 feet, a chord bearing N74°37'43"W a distance of 15.18 feet, and an arc distance of 15.25 feet;  
THENCE the following two (2) courses along easterly lines of said proposed sanitary sewer easement:

1. N15°24'23"W non-tangent with the last described curve a distance of 11.14 feet;
2. THENCE N10°58'23"E non-tangent with the following described curve a distance of 14.18 feet;

THENCE along the arc of a curve to the left, having a central angle of 43°04'49", a radius of 26.00 feet, a chord bearing S62°35'14"E a distance of 19.09 feet, and an arc distance of 19.55 feet;  
THENCE S84°07'39"E tangent with the last and following described curves a distance of 218.95 feet;

THENCE along the arc of a curve to the right, having a central angle of 70°23'05", a radius of 46.00 feet, a chord bearing S48°56'06"E a distance of 53.02 feet, and an arc distance of 56.51 feet;  
THENCE S13°44'34"E tangent with the last described curve a distance of 19.01 feet to the **POINT OF BEGINNING ACCESS C**.

Containing 5,976 net square feet (0.137 Acres), more or less.

Containing 39,942 gross square feet (0.917 Acres), more or less.

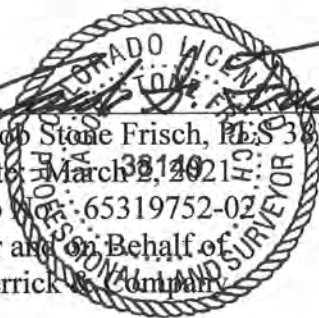

*Jacob Stone Frisch*  
 Jacob Stone Frisch, P.E.S. 38149  
 Date: March 2, 2021  
 Job No.: 65319752-02  
 For and on Behalf of  
 Merrick & Company

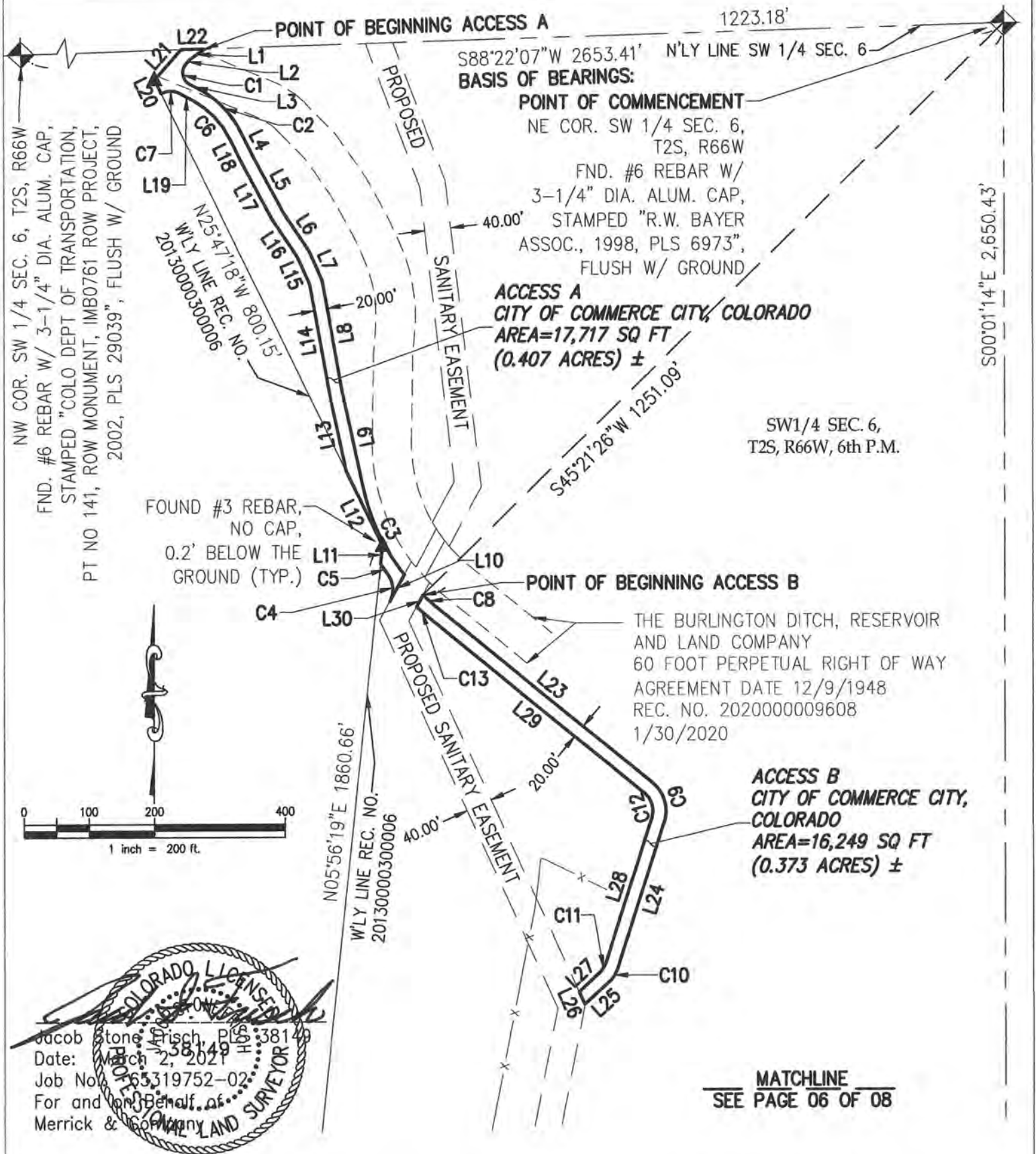

**NOTE**  
 This exhibit does not represent a monumented survey. It is intended only to depict the attached description.

Dwg. JSF  
 Ckd. CP  
 App. JSF



METRO WASTEWATER  
 RECLAMATION DISTRICT

**EXHIBIT B**

Parcel SDI-0229 Access  
 Second Creek Interceptor

DATE:  
 3/02/2021  
 DWG. NO.  
 SDI-229(230)Access  
 SH 5 OF 8

**SEE PAGE 05 OF 08  
MATCHLINE**

SW1/4 SEC. 6,  
T2S, R66W, 6th P.M.

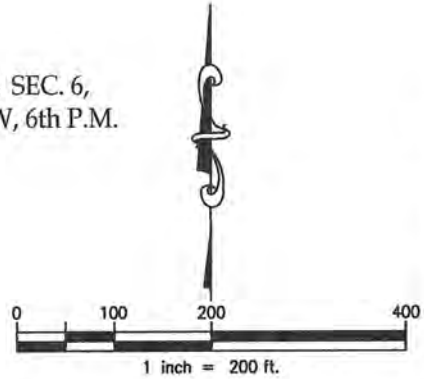

S00°01'14"E 2,650.43'

FOUND #5 REBAR WITH 1-1/4" DIA.  
ORANGE PLASTIC CAP, STAMPED  
"AMERICAN WEST, PLS 38046",  
PROJECTING 0.3' ABOVE THE  
GROUND SURFACE

WLY LINE REC. NO.  
20130000300006

S'LY LINE REC. NO.  
20130000300006

4' BARBED-WIRE FENCE  
PROPOSED SANITARY EASEMENT  
40.00'

**POINT OF COMMENCEMENT ACCESS C**

SE COR. SW 1/4 SEC. 6, T2S, R66W  
FND. 3-1/4" DIA. ALUM. CAP,  
STAMPED "COLO DEPT  
OF TRANSPORTATION,  
1995, PLS 25384",  
0.7' BELOW GROUND

**ACCESS C  
CITY OF  
COMMERCE CITY,  
COLORADO  
AREA=5,976 SQ FT  
(0.137 ACRES) ±**

**POINT OF BEGINNING  
ACCESS C**

N88°36'32"W 566.40'  
S88°21'17"W 1318.09'

0' BRIAN CANAL  
(120' ROW)

30.00'

20.00'

L35

L34

C16

L36

C17

L37

C15

L33

L31

C14

L32

SEC. 7

W 1/16 COR. SECS 6&7, T2S, R66W  
FND #6 REBAR W/  
1" DIA. YELLOW PLASTIC CAP,  
STAMPED "R.W. BAYER, PLS 6973",  
0.2' BELOW THE GROUND  
ATTACHED 3.25" DIA. ALUM. CAP  
TO #6 REBAR,  
STAMPED "2019, PLS 38149"

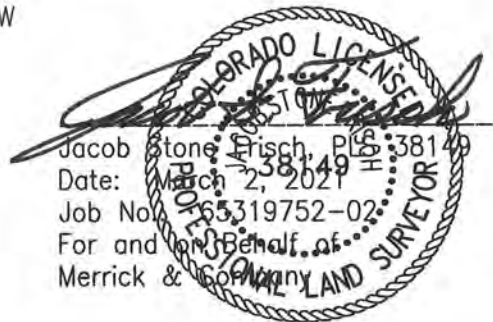

**NOTE**  
This exhibit does not represent a monumented survey. It is intended only to depict the attached description.

Dwg. JSF  
Ckd. CP  
App. JSF

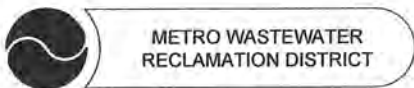

METRO WASTEWATER  
RECLAMATION DISTRICT

**EXHIBIT B**

Parcel SDI-0229 Access  
Second Creek Interceptor

DATE:  
3/02/2021  
DWG. NO.  
SDI-229(230)Access  
SH 6 OF 8

LINE TABLE		
LINE #	BEARING	LENGTH
L1	S54° 50' 20"W	27.84'
L2	S41° 28' 51"W	9.23'
L3	S61° 45' 27"E	17.33'
L4	S26° 01' 15"E	47.03'
L5	S28° 10' 37"E	91.75'
L6	S33° 31' 38"E	71.32'
L7	S23° 44' 01"E	49.92'
L8	S10° 05' 43"E	172.96'
L9	S12° 00' 17"E	154.19'
L10	S28° 11' 28"W	47.56'
L11	N5° 56' 19"E	28.55'
L12	N25° 47' 18"W	127.51'
L13	N12° 00' 17"W	123.82'
L14	N10° 05' 43"W	170.90'
L15	N23° 44' 01"W	45.81'
L16	N33° 31' 38"W	70.54'
L17	N28° 10' 37"W	93.07'
L18	N26° 01' 15"W	47.41'
L19	N61° 45' 27"W	23.12'
L20	N25° 47' 18"W	23.63'

LINE TABLE		
LINE #	BEARING	LENGTH
L21	N41° 24' 24"E	61.76'
L22	N88° 22' 07"E	36.32'
L23	S50° 28' 20"E	428.81'
L24	S17° 31' 06"W	236.32'
L25	S47° 21' 30"W	51.81'
L26	N24° 25' 30"W	21.06'
L27	N47° 21' 30"E	42.03'
L28	N17° 31' 06"E	233.12'
L29	N50° 28' 20"W	428.81'
L30	N28° 11' 28"E	20.77'
L31	S88° 21' 17"W	20.45'
L32	N13° 44' 34"W	14.72'
L33	N84° 07' 39"W	218.95'
L34	N15° 24' 23"W	11.14'
L35	N10° 58' 23"E	14.18'
L36	S84° 07' 39"E	218.95'
L37	S13° 44' 34"E	19.01'

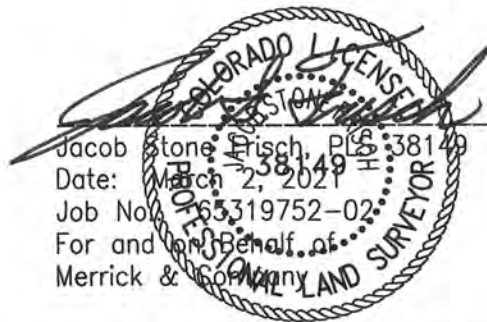

NOTE  
This exhibit does not represent a monumented survey. It is intended only to depict the attached description.

Dwg. JSF  
Ckd. CP  
App. JSF

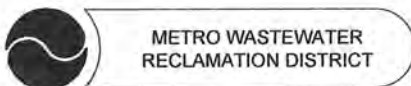

METRO WASTEWATER  
RECLAMATION DISTRICT

**EXHIBIT B**  
Parcel SDI-0229 Access  
Second Creek Interceptor

DATE:  
3/02/2021  
DWG. NO.  
SDI-229(230)Access  
SH 7 OF 8

## CURVE TABLE

CURVE #	DELTA	RADIUS	CHORD BEARING	CHORD LENGTH	LENGTH
C1	103° 14' 18"	20.00'	S10° 08' 18"E	31.36'	36.04'
C2	34° 39' 11"	155.76'	S43° 21' 00"E	92.78'	94.21'
C3	26° 11' 35"	326.00'	S25° 06' 04"E	147.74'	149.03'
C4	63° 46' 30"	40.00'	N3° 41' 47"W	42.26'	44.52'
C5	3° 14' 05"	346.00'	N33° 58' 00"W	19.53'	19.53'
C6	34° 39' 31"	135.74'	N43° 21' 01"W	80.86'	82.11'
C7	56° 58' 31"	30.00'	S89° 45' 18"W	28.62'	29.83'
C8	4° 47' 39"	326.00'	S48° 04' 31"E	27.27'	27.28'
C9	67° 59' 26"	56.00'	S16° 28' 37"E	62.62'	66.45'
C10	29° 50' 24"	46.00'	S32° 26' 18"W	23.69'	23.96'
C11	29° 50' 24"	38.00'	N32° 26' 18"E	19.57'	19.79'
C12	67° 59' 26"	36.00'	N16° 28' 37"W	40.26'	42.72'
C13	3° 50' 19"	346.00'	N48° 33' 11"W	23.18'	23.18'
C14	70° 23' 05"	26.00'	N48° 56' 06"W	29.97'	31.94'
C15	18° 59' 51"	46.00'	N74° 37' 43"W	15.18'	15.25'
C16	43° 04' 49"	26.00'	S62° 35' 14"E	19.09'	19.55'
C17	70° 23' 05"	46.00'	S48° 56' 06"E	53.02'	56.51'

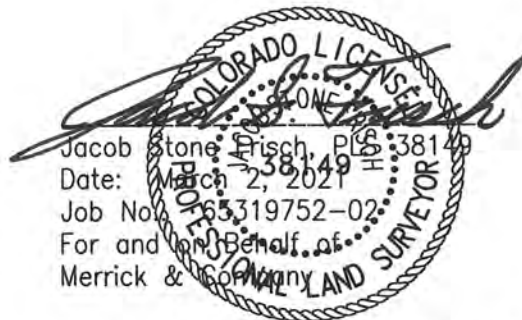

**NOTE**

This exhibit does not represent a monumented survey. It is intended only to depict the attached description.

Dwg. JSF  
 Ckd. CP  
 App. JSF



METRO WASTEWATER  
 RECLAMATION DISTRICT

**EXHIBIT B**

Parcel SDI-0229 Access  
 Second Creek Interceptor

DATE:  
 3/02/2021  
 DWG. NO.  
 SDI-229(230)Access  
 SH 8 OF 8





Job No.: 65319752-02  
File:SDI-0229 (234,282) ACCESS.docx  
Date: March 2, 2021

**EXHIBIT B**  
**PROPERTY DESCRIPTION**  
**PARCEL SDI-0229 ACCESS**

The City of Commerce City, a Colorado municipal Corporation

A Permanent Access Easement being a portion of TRACT N, BUCKLEY RANCH SUBDIVISION, per the plat thereof recorded May 04, 2004 at Reception Number 20040504000312530 in the Adams County Clerk and Recorder's Office, being in a portion of the Northeast Quarter of Section 17, Township 2 South, Range 66 West of the 6th Principal Meridian, County of Adams, State of Colorado, being more particularly described as follows:

**ACCESS A:**

**COMMENCING** at the Center Quarter Corner of said Section 17, whence the North Quarter Corner of said Section 17 bears N00°16'15"E a distance of 2,657.55 feet;  
**THENCE** N00°16'15"E along the westerly line of said Northeast Quarter of Section 17 a distance of 1,013.69 feet to the **POINT OF BEGINNING ACCESS A;**

**THENCE** continuing N00°16'15"E along said westerly line of the Northeast Quarter of Section 17 a distance of 25.68 feet;

**THENCE** N51°25'15"E tangent with the following described curve a distance of 9.08 feet;  
**THENCE** along the arc of a curve to the right, having a central angle of 37°44'36", a radius of 50.00 feet, a chord bearing N70°17'33"E a distance of 32.34 feet, and an arc distance of 32.94 feet;  
**THENCE** N89°09'51"E tangent with the last and following described curves a distance of 319.85 feet;

**THENCE** along the arc of a curve to the left, having a central angle of 16°38'44", a radius of 500.00 feet, a chord bearing N80°50'29"E a distance of 144.75 feet, and an arc distance of 145.26 feet;

**THENCE** N72°31'07"E tangent with the last described curve a distance of 79.89 feet;  
**THENCE** S17°28'53"E along a line being thirty (30.00) feet easterly of and parallel with the westerly line of said TRACT N, also being along the easterly line of a 30.00 foot sanitary sewer easement as recorded January 26, 2000 at Reception Number C0635095, Book 6018 at Page 697 a distance of 192.58 feet;

Jacob Stone 88149 P.E.S. 8149  
Date: March 2, 2021  
Job No.: 65319752-02  
On Behalf of  
Merrick & Company



THENCE N25°07'30"W tangent with the following described curve a distance of 147.88 feet;  
THENCE along the arc of a curve to the left, having a central angle of 82°21'22", a radius of 30.00 feet, a chord bearing N66°18'12"W a distance of 39.50 feet, and an arc distance of 43.12 feet;  
THENCE S72°31'07"W tangent with the last and following described curves a distance of 30.48 feet;  
THENCE along the arc of a curve to the right, having a central angle of 16°38'44", a radius of 520.00 feet, a chord bearing S80°50'29"W a distance of 150.54 feet, and an arc distance of 151.07 feet;  
THENCE S89°09'51"W tangent with the last and following described curves a distance of 319.85 feet;  
THENCE along the arc of a curve to the left, having a central angle of 37°44'36", a radius of 30.00 feet, a chord bearing S70°17'33"W a distance of 19.41 feet, and an arc distance of 19.76 feet;  
THENCE S51°25'15"W tangent with the last described curve a distance of 25.19 feet to the **POINT OF BEGINNING ACCESS A.**

Containing 13,967 net square feet, more or less.

**TOGETHER WITH ACCESS B:**

**COMMENCING** at said Center Quarter Corner of Section 17;

THENCE N63°46'45"E a distance of 938.15 feet to the **POINT OF BEGINNING ACCESS B;**

THENCE N17°28'53"W along a line being 70.00 feet easterly of and parallel with said westerly line of TRACT N a distance of 140.69 feet;

THENCE N09°18'30"W tangent with the following described curve a distance of 88.82 feet;

THENCE along the arc of a curve to the left, having a central angle of 20°14'50", a radius of 320.00 feet, a chord bearing N19°25'55"W a distance of 112.49 feet, and an arc distance of 113.08 feet;

THENCE N29°33'21"W tangent with the last described curve a distance of 42.06 feet;

THENCE N17°28'53"W along a line being 70.00 feet easterly of and parallel with said westerly line of TRACT N a distance of 95.61 feet;

THENCE S29°33'21"E tangent with the following described curve a distance of 135.55 feet;



THENCE along the arc of a curve to the right, having a central angle of  $20^{\circ}14'50''$ , a radius of 340.00 feet, a chord bearing  $S19^{\circ}25'55''E$  a distance of 119.53 feet, and an arc distance of 120.15 feet;

THENCE  $S09^{\circ}18'30''E$  tangent with the last described curve a distance of 228.08 feet to the **POINT OF BEGINNING ACCESS B.**

Containing 7,277 net square feet, more or less.

**TOGETHER WITH ACCESS C:**

**COMMENCING** at said Center Quarter Corner of Section 17;

THENCE  $N78^{\circ}45'07''E$  a distance of 932.77 feet to the **POINT OF BEGINNING ACCESS C;**

THENCE  $N17^{\circ}28'53''W$  along a line being 70.00 feet easterly of and parallel with said westerly line of TRACT N a distance of 31.43 feet;

THENCE  $S56^{\circ}59'38''E$  tangent with the following described curve a distance of 97.62 feet;

THENCE along the arc of a curve to the left, having a central angle of  $29^{\circ}38'16''$ , a radius of 135.00 feet, a chord bearing  $S71^{\circ}48'46''E$  a distance of 69.06 feet, and an arc distance of 69.83 feet;

THENCE  $S86^{\circ}37'54''E$  tangent with the last and following described curves a distance of 127.70 feet;

THENCE along the arc of a curve to the right, having a central angle of  $26^{\circ}03'58''$ , a radius of 100.00 feet, a chord bearing  $S73^{\circ}35'55''E$  a distance of 45.10 feet, and an arc distance of 45.49 feet;

THENCE  $S60^{\circ}33'56''E$  tangent with the last described curve a distance of 2.99 feet;

THENCE  $S89^{\circ}16'36''W$  along a line being 100.00 feet northerly of and parallel with the southerly line of said Northeast Quarter of Section 17 a distance of 119.32 feet;

THENCE  $N86^{\circ}37'54''W$  tangent with the following described curve a distance of 55.32 feet;

THENCE along the arc of a curve to the right, having a central angle of  $29^{\circ}38'16''$ , a radius of 155.00 feet, a chord bearing  $N71^{\circ}48'46''W$  a distance of 79.29 feet, and an arc distance of 80.18 feet;

THENCE  $N56^{\circ}59'38''W$  tangent with the last described curve a distance of 73.37 feet to the **POINT OF BEGINNING ACCESS C.**

Containing 6,015 net square feet, more or less.

Containing 27,259 gross square feet, more or less.

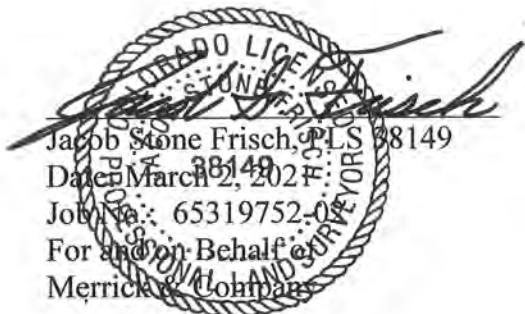

NORTH 1/4 CORNER OF SECTION 17, T2S, R66W  
 FOUND #6 REBAR WITH 3-1/4" DIA. ALUM. CAP,  
 STAMPED "JR ENG, 2008, PLS 30099",  
 0.5' ABOVE THE GROUND SURFACE IN A RANGE BOX

EAST 104TH AVENUE

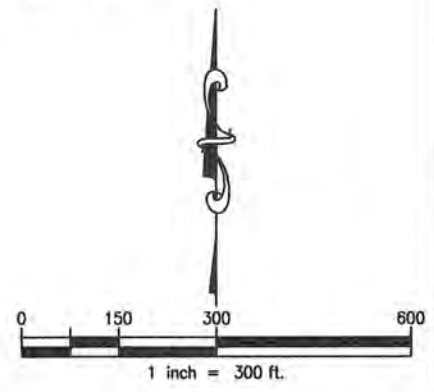

60' WIDE UTILITY EASEMENT FOR GATEWAY AMERICAN PROPERTIES,  
 LLC PER RECEPTION NUMBER C0752628, 01/19/2001 AND  
 RECEPTION NUMBER C0792274, 07/27/2001

BUCKLY RANCH SUBDIVISION  
 RECEPTION NUMBER  
 20040504000312530  
 05/04/2004

30.0' WIDE SANITARY EASEMENT FOR COMMERCE CITY  
 NORTHERN INFRASTRUCTURE GENERAL IMPROVEMENT  
 DISTRICT RECEPTION NUMBER C0635095, BOOK 6018  
 PAGE 697, 01/26/2000

**ACCESS A**  
 The City of Commerce City,  
 a Colorado municipal Corporation  
 AREA=13,967 SQ FT ±

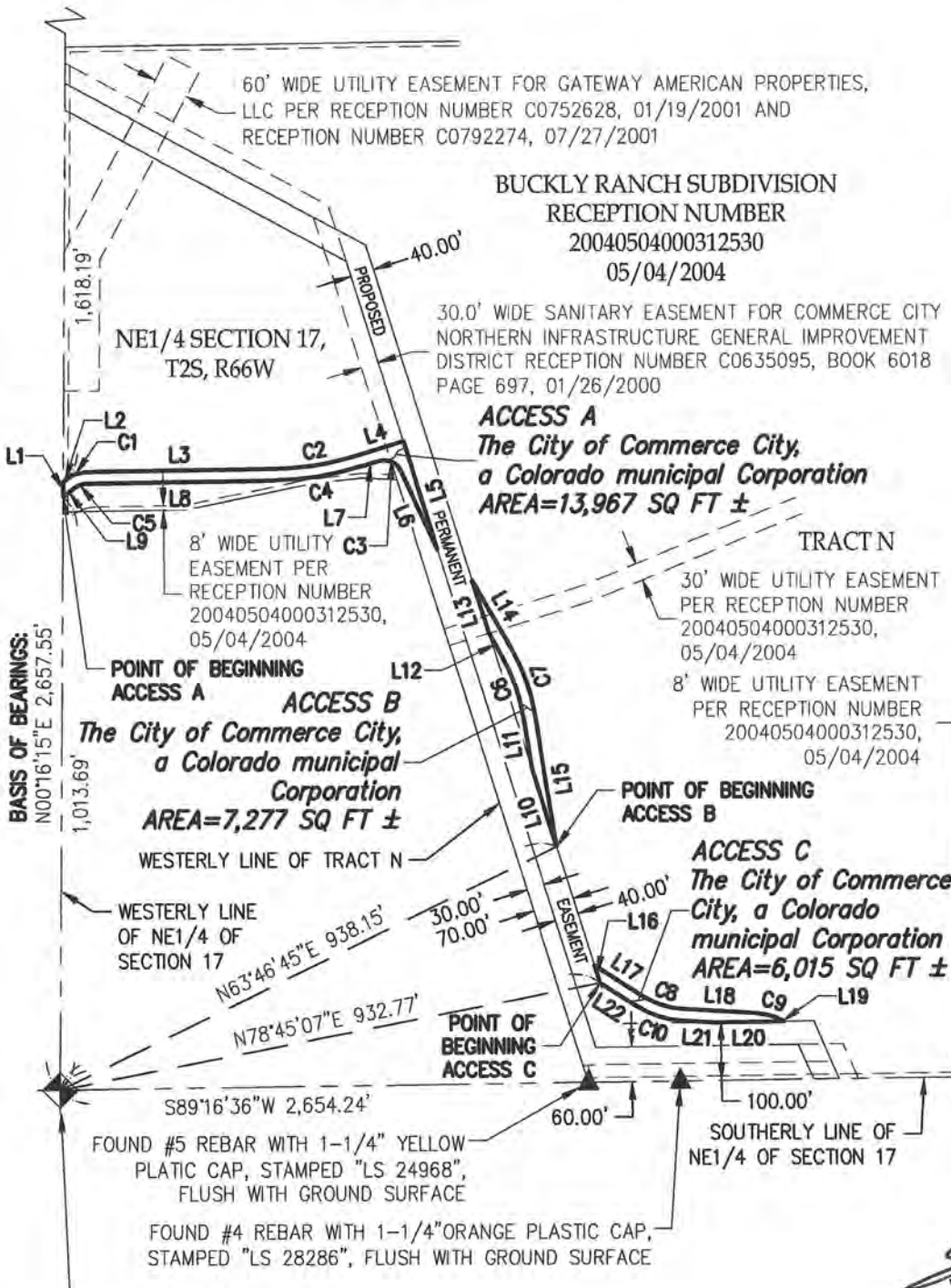

BASIS OF BEARINGS:  
 N00°16'15"E 2,657.55'

POINT OF BEGINNING  
**ACCESS A**  
 The City of Commerce City,  
 a Colorado municipal  
 Corporation  
 AREA=7,277 SQ FT ±

POINT OF BEGINNING  
**ACCESS B**

**ACCESS C**  
 The City of Commerce  
 City, a Colorado  
 municipal Corporation  
 AREA=6,015 SQ FT ±

EAST 1/4 CORNER OF  
 SECTION 16, T2S, R66W  
 FOUND 3-1/4" DIA. ALUM.  
 CAP STAMPED "1995, LS  
 26606", FLUSH WITH  
 GROUND SURFACE

POINT OF COMMENCEMENT  
 CENTER 1/4 OF SECTION 17, T2S, R66W  
 FOUND #6 REBAR WITH 3-1/4" DIA. ALUM. CAP, STAMPED  
 "1999, PLS 25379", FLUSH WITH GROUND SURFACE

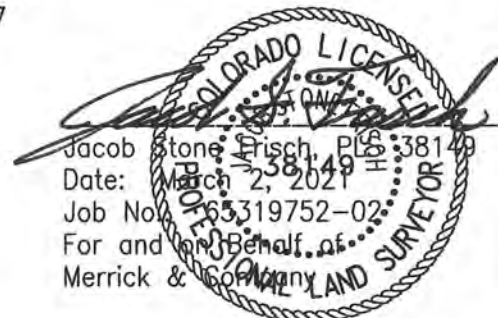

NOTE  
 This exhibit does not represent a monumented survey. It is intended only to depict the attached description.

Dwg. ELZ  
 Ckd. JSF  
 App. JSF

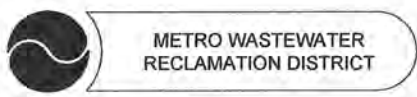

METRO WASTEWATER  
 RECLAMATION DISTRICT

EXHIBIT B  
 Parcel SDI-0229 ACCESS  
 Second Creek Interceptor

DATE:  
 3/02/2021  
 DWG. NO.  
 SDI-0229(234,282) ACCESS  
 SH 4 OF 5

LINE TABLE		
LINE #	BEARING	LENGTH
L1	N0° 16' 15"E	25.68'
L2	N51° 25' 15"E	9.08'
L3	N89° 09' 51"E	319.85'
L4	N72° 31' 07"E	79.89'
L5	S17° 28' 53"E	192.58'
L6	N25° 07' 30"W	147.88'
L7	S72° 31' 07"W	30.48'
L8	S89° 09' 51"W	319.85'
L9	S51° 25' 15"W	25.19'
L10	N17° 28' 53"W	140.69'
L11	N9° 18' 30"W	88.82'

LINE TABLE		
LINE #	BEARING	LENGTH
L12	N29° 33' 21"W	42.06'
L13	N17° 28' 53"W	95.61'
L14	S29° 33' 21"E	135.55'
L15	S9° 18' 30"E	228.08'
L16	N17° 28' 53"W	31.43'
L17	S56° 59' 38"E	97.62'
L18	S86° 37' 54"E	127.70'
L19	S60° 33' 56"E	2.99'
L20	N89° 16' 36"E	119.32'
L21	N86° 37' 54"W	55.32'
L22	N56° 59' 38"W	73.37'

CURVE TABLE					
CURVE #	DELTA	RADIUS	CHORD BEARING	CHORD LENGTH	LENGTH
C1	37° 44' 36"	50.00'	N70° 17' 33"E	32.34'	32.94'
C2	16° 38' 44"	500.00'	N80° 50' 29"E	144.75'	145.26'
C3	82° 21' 22"	30.00'	N66° 18' 12"W	39.50'	43.12'
C4	16° 38' 44"	520.00'	S80° 50' 29"W	150.54'	151.07'
C5	37° 44' 36"	30.00'	S70° 17' 33"W	19.41'	19.76'
C6	20° 14' 50"	320.00'	N19° 25' 55"W	112.49'	113.08'
C7	20° 14' 50"	340.00'	S19° 25' 55"E	119.53'	120.15'
C8	29° 38' 16"	135.00'	S71° 48' 46"E	69.06'	69.83'
C9	26° 03' 58"	100.00'	S73° 35' 55"E	45.10'	45.49'
C10	29° 38' 16"	155.00'	N71° 48' 46"W	79.29'	80.18'

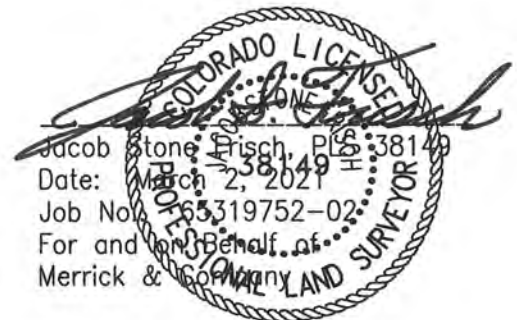

NOTE  
This exhibit does not represent a monumented survey.

Dwg. ELZ  
Ckd. JSF  
App. JSF



METRO WASTEWATER  
RECLAMATION DISTRICT

**EXHIBIT B**  
Parcel SDI-0229 ACCESS  
Second Creek Interceptor

DATE:  
3/02/2021  
DWG. NO.  
SDI-0229(234,282) ACCESS  
SH 5 OF 5



Job No.: 65319752-02  
File: \DWGS\Exhibits & Property Descriptions\SDI-0283 Access A-D.docx  
Date: March 2, 2021

**EXHIBIT B**  
**PROPERTY DESCRIPTION**

**SDI-0229 ACCESS**

City of Commerce City, a Colorado Municipal Corporation

Permanent Access Easements being portions of TRACT H, FRONTERRA VILLAGE FILING NO. 3, according to the plat thereof recorded December 20, 2002 at File 18 Map 816, Reception No. C1070335 in the Adams County Clerk and Recorder's Office, being in a portion of the Southeast Quarter of Section 17, Township 2 South, Range 66 West of the 6<sup>th</sup> Principal Meridian, County of Adams, State of Colorado, being more particularly described as follows:

**ACCESS A:**

**COMMENCING** at the Center Quarter Corner of said Section 17, whence the East Quarter Corner of said Section 17 bears N89°16'36"E a distance of 2,654.24 feet;  
**THENCE** S86°21'29"E a distance of 1,322.85 feet to the **POINT OF BEGINNING ACCESS A;**

**THENCE** S23°27'02"E along the westerly line of a proposed permanent sanitary sewer easement, non-tangent with the following described curve a distance of 274.27 feet;

**THENCE** along the arc of a curve to the right, having a central angle of 38°42'16", a radius of 370.00 feet, a chord bearing N25°34'08"W a distance of 245.22 feet, and an arc distance of 249.94 feet;

**THENCE** N06°13'00"W tangent with the last described curve a distance of 30.59 feet to the **POINT OF BEGINNING ACCESS A.**

Containing 4,680 net square feet, more or less.

**TOGETHER WITH ACCESS B:**

**COMMENCING** at said Center Quarter Corner of Section 17;  
**THENCE** S73°51'06"E a distance of 1,580.35 feet to the **POINT OF BEGINNING ACCESS B;**



THENCE S63°27'06"E tangent with the following described curve a distance of 59.62 feet;  
THENCE along the arc of a curve to the right, having a central angle of 21°52'17", a radius of 115.00 feet, a chord bearing S52°30'57"E a distance of 43.63 feet, and an arc distance of 43.90 feet;  
THENCE S41°34'48"E tangent with the last and following described curves a distance of 19.31 feet;

THENCE along the arc of a curve to the right, having a central angle of 30°20'58", a radius of 315.00 feet, a chord bearing S26°24'19"E a distance of 164.91 feet, and an arc distance of 166.85 feet;

THENCE S11°13'51"E tangent with the last described curve a distance of 162.65 feet;

THENCE S23°46'11"E a distance of 23.87 feet;

THENCE S06°30'06"E a distance of 136.31 feet;

THENCE N23°27'02"W along the westerly line of a parcel of land described in Reception No. C0612528, recorded November 12, 1999 in the Adams County Clerk and Recorder's Office, said line also being the easterly line of said proposed sanitary sewer easement a distance of 68.80 feet;

THENCE the following two (2) courses along westerly lines of said TRACT H:

1. N06°30'09"W a distance of 67.64 feet;
2. THENCE N23°45'45"W a distance of 22.84 feet;

THENCE N11°13'51"W tangent with the following described curve a distance of 164.84 feet;

THENCE along the arc of a curve to the left, having a central angle of 30°20'58", a radius of 295.00 feet, a chord bearing N26°24'19"W a distance of 154.44 feet, and an arc distance of 156.26 feet;

THENCE N41°34'48"W tangent with the last and following described curves a distance of 19.31 feet;

THENCE along the arc of a curve to the left, having a central angle of 21°52'17", a radius of 95.00 feet, a chord bearing N52°30'57"W a distance of 36.04 feet, and an arc distance of 36.26 feet;

THENCE N63°27'06"W tangent with the last described curve a distance of 35.79 feet;

THENCE N23°27'02"W along said westerly line of that parcel of land described in Reception No. C0612528, and said easterly line of that proposed sanitary sewer easement a distance of 31.11 feet to the **POINT OF BEGINNING ACCESS B**.

Containing 11,160 net square feet, more or less.

#### **TOGETHER WITH ACCESS C:**

**COMMENCING** at the Southeast Corner of said Section 17, whence the South Quarter Corner of said Section 17 bears S89°04'32"W a distance of 2,659.36 feet;

THENCE N24°00'16"W a distance of 395.84 feet to the **POINT OF BEGINNING ACCESS C**;



Jacob Stone Frisch, P.L.S. 38149  
Date: March 2, 2021  
Job No.: 65319752-02  
For and on Behalf of  
Merrick & Company

THENCE N33°02'48"W along said westerly line of that parcel of land described in Reception No. C0612528, and said easterly line of that proposed sanitary sewer easement a distance of 42.46 feet; THENCE N04°56'49"W tangent with the following described curve a distance of 42.53 feet; THENCE along the arc of a curve to the left, having a central angle of 54°06'40", a radius of 149.00 feet, a chord bearing N32°00'09"W a distance of 135.55 feet, and an arc distance of 140.72 feet; THENCE N59°03'29"W tangent with the last described curve a distance of 51.31 feet; THENCE N33°02'48"W along said westerly line of that parcel of land described in Reception No. C0612528, and said easterly line of that proposed sanitary sewer easement a distance of 45.60 feet; THENCE S59°03'29"E tangent with the following described curve a distance of 92.30 feet; THENCE along the arc of a curve to the right, having a central angle of 54°06'40", a radius of 169.00 feet, a chord bearing S32°00'09"E a distance of 153.74 feet, and an arc distance of 159.61 feet; THENCE S04°56'49"E tangent with the last described curve a distance of 79.99 feet to the **POINT OF BEGINNING ACCESS C.**

Containing 5,665 net square feet, more or less.

**TOGETHER WITH ACCESS D:**

**COMMENCING** at said Southeast Corner of Section 17;  
THENCE N49°49'37"W a distance of 243.40 feet to the **POINT OF BEGINNING ACCESS D;**

THENCE N14°02'57"W a distance of 69.97 feet;  
THENCE N07°28'52"E a distance of 107.27 feet;  
THENCE S33°02'48"E along said westerly line of a proposed permanent sanitary sewer easement a distance of 30.78 feet;  
THENCE S07°28'52"W a distance of 80.07 feet;  
THENCE S14°02'57"E to a distance of 70.83 feet;  
THENCE S89°04'32"W along said southerly line of TRACT H a distance of 20.54 feet to the **POINT OF BEGINNING ACCESS D.**

Containing 3,281 net square feet, more or less.

Containing 24,786 gross square feet, more or less.

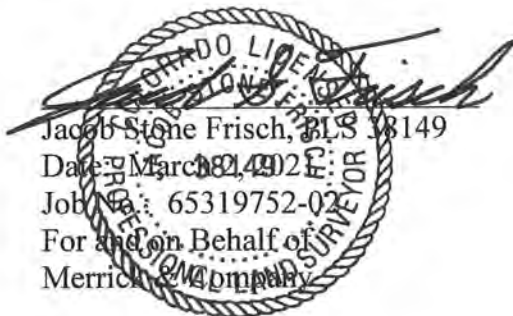

Jacob Stone Frisch, SLS 38149  
Date: March 18, 2012  
Job No.: 65319752-02  
For and on Behalf of  
Merrick & Company



**POINT OF COMMENCEMENT ACCESS A/B**

CENTER 1/4 CORNER OF SECTION 17,  
TOWNSHIP 2 SOUTH, RANGE 66 WEST  
FOUND #6 REBAR WITH 3-1/4" DIA.  
ALUM CAP, STAMPED "C1/4 SEC 17  
T2S R66W, JOHNSTON ENG ASSOC,  
1999, PLS 25379", FLUSH WITH THE  
GROUND SURFACE

EAST 1/4 CORNER OF SECTION 17,  
TOWNSHIP 2 SOUTH RANGE 66 WEST  
FOUND 3-1/4" DIA. ALUMINUM CAP  
ON #6 REBAR, STAMPED "1/4 S16  
S17 T2S R66W, 1995, LS 26606",  
FLUSH WITH THE GROUND SURFACE

N'LY LINE OF  
TRACT H

**BASIS OF BEARINGS: N89°16'36"E 2,654.24'**

TRACT H

FRONTERRA VILLAGE FILING NO. 3

FILE 18 MAP 816

RECEPTION NUMBER C1070335

DATED 12/20/2002

**POINT OF  
BEGINNING  
ACCESS A**

**ACCESS A**

**CITY OF COMMERCE CITY,  
A COLORADO MUNICIPAL CORPORATION  
AREA=4,680 SQ FT ±**

30.0' WIDE EXCLUSIVE SANITARY EASEMENT  
FOR COMMERCE CITY NORTHERN  
INFRASTRUCTURE GENERAL IMPROVEMENT  
DISTRICT PER RECEPTION NUMBER C0612528  
BOOK 5952 PAGE 111, DATED 11/12/1999

30.0' WIDE SANITARY EASEMENT  
PER FILE 18 MAP 816,  
RECEPTION NUMBER C1070335,  
DATED 12/22/2002

FOUND #5 REBAR WITH  
1-1/4" DIA. ORANGE  
PLASTIC CAP, STAMPED  
"PLS 28286", FLUSH WITH  
THE GROUND SURFACE

FOUND #5 REBAR WITH  
1-1/4" DIA. ORANGE  
PLASTIC CAP, STAMPED  
"PLS 28286", PROJECTING  
0.3' ABOVE GROUND SURFACE

**POINT OF  
BEGINNING  
ACCESS B**

**MATCHLINE**

SEE PAGE 6 OF 7

**ACCESS B**

**CITY OF COMMERCE CITY,  
A COLORADO MUNICIPAL CORPORATION  
AREA=11,160 SQ FT ±**

SE 1/4  
SECTION 17,  
T2S, R66W

WESTERLY LINE OF  
RECEPTION NUMBER  
C0612528, BOOK 5952  
PAGE 111

WESTERLY LINES  
OF TRACT H

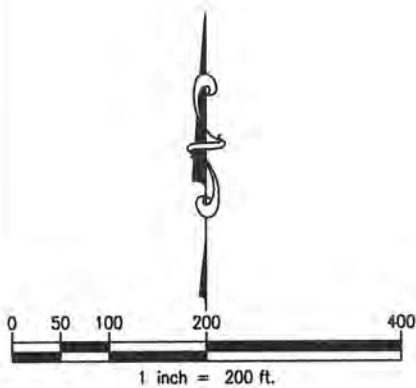

**COLORADO LICENSE**  
*Jacob Stone Frisch*  
Jacob Stone Frisch, PLS #38149  
Date: March 2, 2021  
Job No. 265319752-02  
For and on Behalf of  
Merrick & Co. LAND SURVEYOR

**NOTE**  
This exhibit does not represent a monumented survey. It is intended only to depict the attached description.

<p>Dwg. <u>ACC/GAG</u></p> <p>Ckd. <u>JSF</u></p> <p>App. <u>JSF</u></p>	 <p><b>METRO WASTEWATER RECLAMATION DISTRICT</b></p>	<p><b>Exhibit B Access</b></p> <p>Parcel SDI-0229</p> <p>Second Creek Interceptor</p>	<p>DATE: 03/02/2021</p> <p>DWG. NO. SDI-0283_ACCESS</p> <p>SH 4 OF 8</p>
--	---	---	--

FOR COMMERCE CITY TOWNSHIP  
 INFRASTRUCTURE GENERAL IMPROVEMENT  
 DISTRICT PER RECEPTION NUMBER C0612528,  
 BOOK 5952 PAGE 111, DATED 11/12/1999

SEE PAGE 4 OF 7  
 MATCHLINE

TRACT H  
 FRONTERRA VILLAGE FILING NO. 3  
 FILE 18 MAP 816  
 RECEPTION NUMBER C1070335  
 DATED 12/20/2002

ACCESS B  
 CITY OF COMMERCE CITY,  
 A COLORADO MUNICIPAL  
 CORPORATION  
 AREA=11,160 SQ FT ±

SE 1/4  
 SECTION 17,  
 T2S, R66W

30.0' WIDE EXCLUSIVE SANITARY EASEMENT  
 FOR COMMERCE CITY NORTHERN  
 INFRASTRUCTURE GENERAL IMPROVEMENT  
 DISTRICT PER RECEPTION NUMBER C0612528,  
 BOOK 5952 PAGE 111, DATED 11/12/1999

SOUTH 1/16 CORNER OF SECTION 17&16,  
 TOWNSHIP 2 SOUTH, RANGE 66 WEST  
 FOUND #6 REBAR WITH 3-1/4" DIA.  
 ALUMINUM CAP, STAMPED  
 "JR ENG, 1999, LS 25369",  
 0.5' BELOW THE GROUND SURFACE

WESTERLY LINE OF  
 RECEPTION NUMBER  
 C0612528, BOOK 5952  
 PAGE 111

TRACT H  
 FRONTERRA VILLAGE FILING NO. 3  
 FILE 18 MAP 816  
 RECEPTION NUMBER C1070335  
 DATED 12/20/2002

N00°09'33"E 1320.28'

MATCHLINE  
 SEE PAGE 6 OF 7

W'LY LINES  
 OF TRACT H

PROPOSED SANITARY ESMT.

PROPO

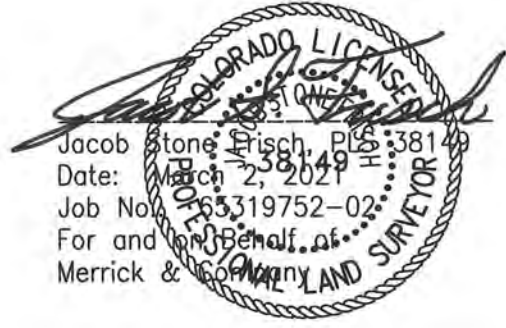
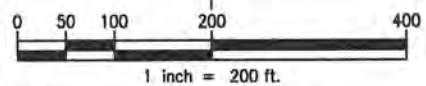

Jacob Stone, Frisch, PLLC 38149  
 Date: March 2, 2021  
 Job No. 63319752-02  
 For and on behalf of  
 Merrick & Co.

NOTE  
 This exhibit does not represent a monumented survey. It is intended only to depict the attached description.

Dwg. ACC/GAG Ckd. JSF App. JSF	 METRO WASTEWATER RECLAMATION DISTRICT	Exhibit B Parcel SDI-0229 Access Second Creek Interceptor	DATE: 03/02/2021 DWG. NO. SDI-0283_ACCESS SH 5 OF 7
--------------------------------------	--	---	---

SEE PAGE 5 OF 7  
MATCHLINE

SE 1/4  
SECTION 17,  
T2S, R66W

30.0' WIDE EXCLUSIVE SANITARY EASEMENT  
FOR COMMERCE CITY NORTHERN  
INFRASTRUCTURE GENERAL IMPROVEMENT  
DISTRICT PER RECEPTION NUMBER C0612528,  
BOOK 5952 PAGE 111, DATED 11/12/1999

WESTERLY LINE OF  
RECEPTION NUMBER  
C0612528, BOOK 5952  
PAGE 111

ACCESS C  
CITY OF COMMERCE CITY,  
A COLORADO MUNICIPAL  
CORPORATION  
AREA=5,665 SQ FT ±

ACCESS D  
CITY OF COMMERCE CITY,  
A COLORADO MUNICIPAL  
CORPORATION  
AREA=3,281 SQ FT ±

POINT OF  
BEGINNING  
ACCESS C

POINT OF  
BEGINNING  
ACCESS D

SOUTH 1/4 CORNER OF  
SECTION 17, T2S, R66W  
FOUND ILLEGIBLE 3-1/4"  
DIA. ALUMINUM CAP,  
1.0' BELOW ASPHALT  
ROAD SURFACE IN A  
MONUMENT BOX

W'LY LINES  
OF TRACT H

S'LY LINE OF TRACT H

S89°04'32"W 2659.36'  
EAST 96TH AVENUE

POINT OF COMMENCEMENT ACCESS C/D  
SOUTHEAST CORNER OF SECTION 17  
TOWNSHIP 2 SOUTH, RANGE 66 WEST  
FOUND #5 REBAR WITH 3-1/4"  
DIA. ALUMINUM CAP, STAMPED  
"CWC CONSULTING GROUP,  
MOLLENHAUER, 2016, PLS 37890",  
FLUSH WITH THE GROUND SURFACE

L19 20.00'  
L18  
L17  
C7  
C6  
L16  
L15  
L23  
L24  
L25  
L22  
L21  
L26  
395.84'  
N24°00'16"W  
243.40'  
N49°49'37"W

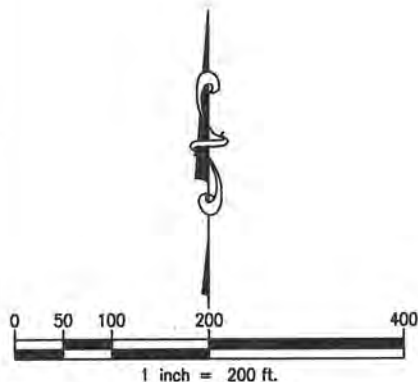

Jacob Stone Frisch, PLS 38149  
Date: March 2, 2021  
Job No. 65319752-02  
For and on Behalf of Merrick & Co.  
COLORADO LICENSE  
SURVEYOR

NOTE  
This exhibit does not represent a monumented survey. It is intended only to depict the attached description.

Dwg. ACC/GAG Ckd. JSF App. JSF	 METRO WASTEWATER RECLAMATION DISTRICT	Exhibit B Parcel SDI-0229 Access Second Creek Interceptor	DATE: 03/02/2021 DWG. NO. SDI-0283_ACCESS SH 6 OF 7
--------------------------------------	--	---	---

LINE TABLE		
LINE #	BEARING	LENGTH
L1	S23°27'02"E	274.27'
L2	N6°13'00"W	30.59'
L3	S63°27'06"E	59.62'
L4	S41°34'48"E	19.31'
L5	N11°13'51"W	162.65'
L6	S23°46'11"E	23.87'
L7	S6°30'06"E	136.31'
L8	N23°27'02"W	68.80'
L9	N6°30'09"W	67.64'

LINE TABLE		
LINE #	BEARING	LENGTH
L10	N23°45'45"W	22.84'
L11	N11°13'51"W	164.84'
L12	N41°34'48"W	19.31'
L13	N63°27'06"W	35.79'
L14	N23°27'02"W	31.11'
L15	N33°02'48"W	42.46'
L16	N4°56'49"W	42.53'
L17	N59°03'29"W	51.31'
L18	N33°02'48"W	45.60'

LINE TABLE		
LINE #	BEARING	LENGTH
L19	S59°03'29"E	92.30'
L20	S4°56'49"E	79.99'
L21	N14°02'57"W	69.97'
L22	N7°28'52"E	107.27'
L23	S33°02'48"E	30.78'
L24	S7°28'52"W	80.07'
L25	S14°02'57"E	70.83'
L26	S89°04'32"W	20.54'

CURVE TABLE					
CURVE #	DELTA	RADIUS	CHORD BEARING	CHORD LENGTH	LENGTH
C1	38°42'16"	370.00'	N25°34'08"W	245.22'	249.94'
C2	21°52'17"	115.00'	S52°30'57"E	43.63'	43.90'
C3	30°20'58"	315.00'	S26°24'19"E	164.91'	166.85'
C4	30°20'58"	295.00'	N26°24'19"W	154.44'	156.26'
C5	21°52'17"	95.00'	N52°30'57"W	36.04'	36.26'
C6	54°06'40"	149.00'	N32°00'09"W	135.55'	140.72'
C7	54°06'40"	169.00'	S32°00'09"E	153.74'	159.61'

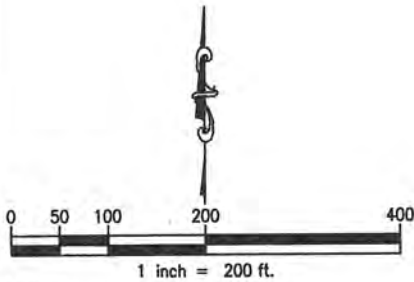

Jacob Stone Frisch, PLS: 38149  
 Date: March 2, 2021  
 Job No. 65319752-02  
 For and on Behalf of Merrick & ...

**NOTE**  
 This exhibit does not represent a monumented survey. It is intended only to depict the attached description.

Dwg. <u>ACC/GAG</u> Ckd. <u>JSF</u> App. <u>JSF</u>	 <b>METRO WASTEWATER RECLAMATION DISTRICT</b>	<b>Exhibit B</b> Parcel SDI-0229 Access Second Creek Interceptor	DATE: 03/02/2021
			DWG. NO. SDI-0283_ACCESS
			SH 7 OF 7



Job No.: 65319752-02  
File: SDI-0229 (267,291,365) ACCESS-R1.docx  
Date: September 8, 2022

**EXHIBIT B**  
**PROPERTY DESCRIPTION**  
**PARCEL SDI-0229 ACCESS**

City of Commerce City, a Municipal Corporation

A Permanent Sanitary Sewer Easement being a portion of TRACT G and a portion of TRACT H, BUFFALO HIGHLANDS FILING NO. 1 according to the plat thereof recorded December 15, 2016 at Reception Number 2016000109618 in the Adams County Clerk and Recorder's Office, being in the West Half of Section 21, Township 2 South, Range 66 West of the 6<sup>th</sup> Principal Meridian, County of Adams, State of Colorado, being more particularly described as follows:

**ACCESS A:**

**COMMENCING** at the Northwest corner of said Section 21, whence the West Quarter corner of said Section 21 bears S00°12'07"W a distance of 2667.13 feet;  
**THENCE** S00°12'07"W along the westerly line of said West Half of Section 21 a distance of 89.65 feet to the **POINT OF BEGINNING ACCESS A;**

**THENCE** N89°49'23"E tangent with the following described curve a distance of 217.70 feet;  
**THENCE** along the arc of a curve to the right having a central angle of 26°14'04", a radius of 33.50 feet, a chord bearing S77°03'35"E a distance of 15.21 feet, and an arc distance of 15.34 feet;

**THENCE** S63°56'33"E tangent with the last described curve, non-tangent with the following described curve a distance of 51.21 feet;

**THENCE** along the southerly line of said TRACT H, along the arc of a curve to the right having a central angle of 01°57'02", a radius of 890.00 feet, a chord bearing S74°44'57"W a distance of 30.30 feet, and an arc distance of 30.30 feet;

**THENCE** N63°56'33"W non-tangent with the last described curve, tangent with the following described curve a distance of 28.45 feet;

**THENCE** along the arc of a curve to the left having a central angle of 26°14'04", a radius of 13.50 feet, a chord bearing N77°03'35"W a distance of 6.13 feet, and an arc distance of 6.18 feet;

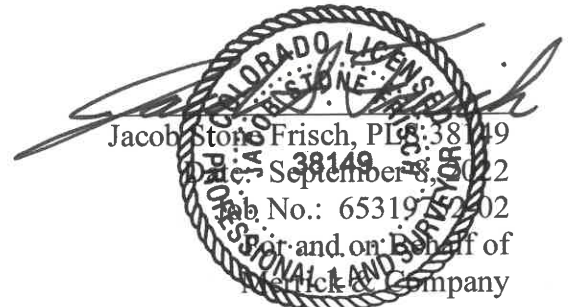



THENCE S89°49'23"W a distance of 217.83 feet;  
THENCE N01°12'07"E along said westerly line of the West Half of Section 21 a distance of 20.00 feet to the **POINT OF BEGINNING ACCESS A.**

Containing 5,370 net square feet (0.123 Acres), more or less.

**TOGETHER WITH ACCESS B:**

**COMMENCING** at said Northwest corner of Section 21;  
THENCE S00°12'07"W along said westerly line of the West Half of Section 21 a distance of 339.33 feet to the **POINT OF BEGINNING ACCESS B;**

THENCE N62°58'55"E tangent with the following described curve a distance of 79.14 feet;  
THENCE along the arc of a curve to the right having a central angle of 06°26'22', a radius of 510.00 feet, a chord bearing N66°12'06"E a distance of 57.29 feet, and an arc distance of 57.32 feet;  
THENCE N69°25'17"E tangent with the last described curve, non-tangent with the following described curve a distance of 59.03 feet;  
THENCE along the northerly line of said TRACT G, along the arc of a curve to the left having a central angle of 07°57'29", a radius of 1010.00 feet, a chord bearing N77°37'28"E a distance of 140.17 feet, and an arc distance of 140.28 feet;  
THENCE S69°25'17"W non-tangent with the last described curve, tangent with the following described curve a distance of 197.77 feet;  
THENCE along the arc of a curve to the left having a central angle of 06°26'22', a radius of 490.00 feet, a chord bearing S66°12'06"W a distance of 55.04 feet, and an arc distance of 55.07 feet;  
THENCE S62°58'55"W tangent with the last described curve a distance of 89.43 feet;  
THENCE N00°12'07"E along said westerly line of the West Half of Section 21 a distance of 22.49 feet to the **POINT OF BEGINNING ACCESS B.**

Containing 5,150 net square feet (0.118 Acres), more or less.

Containing 10,520 gross square feet (0.241 Acres), more or less.

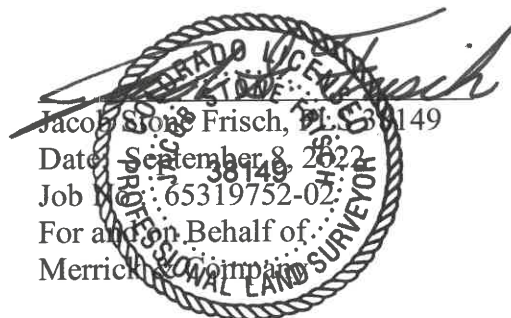

**POINT OF COMMENCEMENT**  
 NW COR. OF SEC. 21, T2S, R66W  
 FND. #5 REBAR WITH 3-1/4" DIA.  
 ALUM. CAP, STAMPED " 2016,  
 PLS 37890", FLUSH WITH GRD

30' WIDE PIPELINE EASEMENT  
 FOR THE SINCLAIR PIPELINE  
 COMPANY, LLC  
 REC. NUMBER C0435113,  
 BOOK 5442 PG 33

**ACCESS A**  
 AREA=5,370 SQ FT  
 (0.123 ACRES) ±

Δ=26°14'04"  
 R=33.50'  
 CB=S77°03'35"E  
 C=15.21'  
 A=15.34'  
 S63°56'33"E  
 51.21'

TRACT H,  
 BUFFALO HIGHLANDS,  
 FILING NO. 1

EAST 96TH AVE.

**POINT OF BEGINNING ACCESS A**

N00°12'07"E 20.00'

N89°49'23"E 217.70'

Δ=1°57'02"  
 R=890.00'  
 CB=S74°44'57"W  
 C=30.30'  
 A=30.30'

S89°49'23"W 217.83'

Δ=7°57'29"  
 R=1010.00'  
 CB=N77°37'28"E  
 C=140.17'  
 A=140.28'

CB=N77°03'35"W

N63°56'33"W  
 28.45'

N69°25'17"E  
 59.03'

10' WIDE UTILITY EASEMENT  
 REC. NO. 201600019618,  
 REC. NO. 2013000090445

Δ=6°26'22"  
 R=510.00'  
 CB=N66°12'06"E  
 C=57.29'  
 A=57.32'

N62°58'55"E 79.14'

**ACCESS B**  
 AREA=5,150 SQ FT  
 (0.118 ACRES) ±

TRACT G, BUFFALO  
 HIGHLANDS, FILING NO. 1

**POINT OF BEGINNING ACCESS B**

N00°12'07"E 22.49'

Δ=6°26'22"  
 R=490.00'  
 CB=S66°12'06"W  
 C=55.04'  
 A=55.07'

10' WIDE EASEMENT FOR  
 THE PUBLIC SERVICE  
 COMPANY OF COLORADO  
 REC. NO. 2015000063473

S62°58'55"W 89.43'

30.00' WIDE EXCLUSIVE EASEMENT FOR THE COMMERCE CITY  
 NORTHERN INFRASTRUCTURE GENERAL IMPROVEMENT DISTRICT  
 PER REC. NO. C0615133, BOOK 5959 PG 506, 11/22/1999,  
 AMENDED PER REC. NO. C0900508, 12/14/2001

W 1/4 COR. SEC. 21,  
 T2S, R66W  
 FND. 3-1/4" DIA. BRASS CAP,  
 STAMPED "2012, PLS 34988",  
 0.2' BELOW GRD

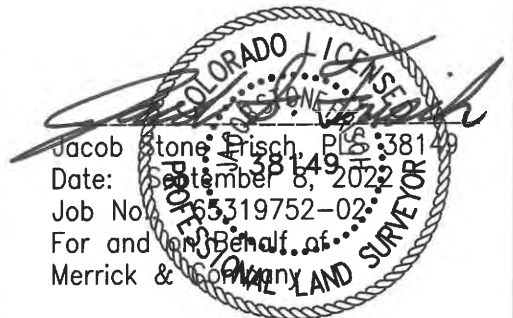

**NOTE**  
 This exhibit does not represent a monumented survey. It is intended only to depict the attached description.

Dwg. CWS  
 Ckd. JSF  
 App. JSF



METRO WASTEWATER  
 RECLAMATION DISTRICT

**EXHIBIT B**

Parcel SDI-0229 Access  
 Second Creek Interceptor

DATE:  
 9/08/2022  
 DWG. NO.  
 SDI-0229(291) ACCESS  
 SH 3 OF 3



Job No.: 65319752-02  
File: SDI-0229 (265,292) ACCESS-R1 .docx  
Date: September 8, 2022

**EXHIBIT B**  
**PROPERTY DESCRIPTION**  
**PARCEL SDI-0229 ACCESS**

City of Commerce City, Colorado, a Colorado Municipal Corporation

Permanent Access Easements being portions of a parcel of land described as Parcel C in Deed recorded August 27, 2007 at Reception Number 2007000082031 in the Adams County Clerk and Recorder's Office, being in a portion of the Northeast Quarter of Section 20, Township 2 South, Range 66 West of the 6th Principal Meridian, County of Adams, State of Colorado, being more particularly described as follows:

**ACCESS A:**

**COMMENCING** at the Northeast Corner of said Section 20, whence the East Quarter Corner of said Section 20 bears S00°12'07"W a distance of 2,667.13 feet;  
**THENCE** S00°12'07"W along the easterly line of said Northeast Quarter of Section 20 a distance of 100.02 feet to the **POINT OF BEGINNING ACCESS A;**

**THENCE** continuing S00°12'07"W along said easterly line of the Northeast Quarter of Section 20 a distance of 9.63 feet;  
**THENCE** S89°49'23"W a distance of 25.06 feet;  
**THENCE** N00°07'55"E along the easterly line of a proposed sanitary sewer easement a distance of 9.31 feet;  
**THENCE** N89°04'32"E along the northerly line of said Parcel C a distance of 25.07 feet to the **POINT OF BEGINNING ACCESS A.**

Containing 237 net square feet, more or less.

**TOGETHER WITH ACCESS B:**

**COMMENCING** at said Northeast Corner of said Section 20;  
**THENCE** S00°12'07"W along said easterly line of the Northeast Quarter of Section 20 a distance of 339.33 feet to the **POINT OF BEGINNING ACCESS B;**  
**THENCE** continuing S00°12'07"W along said easterly line of the Northeast Quarter of Section 20 a distance of 22.49 feet;

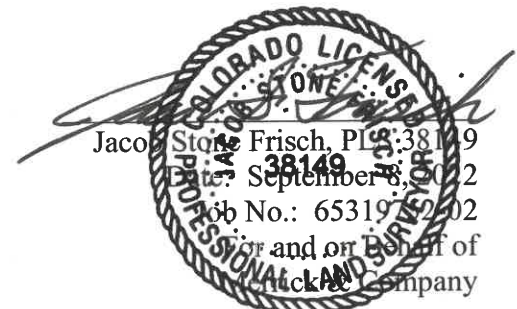





THENCE S62°58'55"W a distance of 22.59 feet;  
THENCE N04°21'53"W along said easterly line of that proposed sanitary sewer easement a distance of 21.67 feet;  
THENCE N62°58'55"E a distance of 24.53 feet to the **POINT OF BEGINNING ACCESS B**.

Containing 471 net square feet, more or less.

**TOGETHER WITH ACCESS C:**

**COMMENCING** at said Northeast Corner of said Section 20;  
THENCE S02°52'17"W a distance of 711.74 feet to the **POINT OF BEGINNING ACCESS B**;

THENCE S04°21'53"E along the westerly line of said proposed sanitary sewer easement a distance of 24.50 feet;  
THENCE N59°05'16"W tangent with the following described curve a distance of 107.47 feet;  
THENCE along the arc of a curve to the left, tangent with the following described curve having a central angle of 90°00'00", a radius of 12.50 feet, a chord bearing S75°54'44"W a distance of 17.68 feet, and an arc distance of 19.63 feet;  
THENCE along the arc of a curve to the left, tangent with the last described curve having a central angle of 57°50'33", a radius of 170.22 feet, a chord bearing S02°01'57"W a distance of 164.64 feet, and an arc distance of 171.85 feet;  
THENCE S26°55'49"E tangent with the last and following described curves a distance of 80.51 feet;  
THENCE along the arc of a curve to the right, having a central angle of 95°32'50", a radius of 150.00 feet, a chord bearing S20°50'36"W a distance of 222.15 feet, and an arc distance of 250.14 feet;  
THENCE S68°37'01"W tangent with the last described curve a distance of 78.79 feet;  
THENCE the following four (4) courses along the westerly lines of said Parcel C:

1. N15°58'38"W a distance of 477.42 feet;
2. THENCE N16°48'07"W tangent with the following described curve a distance of 172.71 feet;
3. THENCE along the arc of a curve to the left, tangent with the following described curve having a central angle of 21°23'45", a radius of 975.00 feet, a chord bearing N27°30'00"W a distance of 361.98 feet, and an arc distance of 364.09 feet;
4. THENCE along the arc of a curve to the left, tangent with the last described curve having a central angle of 19°15'25", a radius of 445.00 feet, a chord bearing N47°49'34"W a distance of 148.86 feet, and an arc distance of 149.56 feet;

THENCE N89°04'32"E along said northerly line of Parcel C, non-tangent with the last and following described curves a distance of 34.64 feet;

THENCE the following four (4) courses along a line being 20.00 feet easterly of and parallel with said westerly lines of Parcel C:

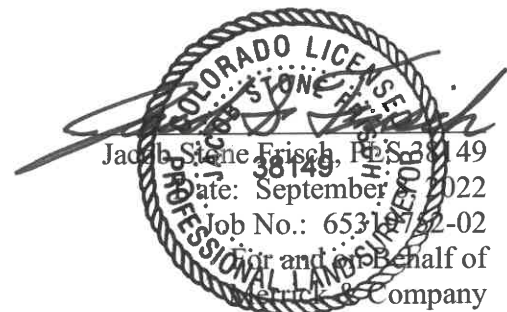



1. along the arc of a curve to the right, tangent with the following described curve having a central angle of 15°41'40", a radius of 465.00 feet, a chord bearing S46°02'42"E a distance of 126.98 feet, and an arc distance of 127.37 feet;
  2. THENCE along the arc of a curve to the right, tangent with the last described curve having a central angle of 21°23'45", a radius of 995.00 feet, a chord bearing S27°30'00"E a distance of 369.41 feet, and an arc distance of 371.56 feet;
  3. THENCE S16°48'07"E tangent with the last described curve a distance of 172.85 feet;
  4. THENCE S15°58'38"E tangent with the following described curve a distance of 441.84 feet;
- THENCE along the arc of a curve to the left, having a central angle of 95°24'41", a radius of 12.50 feet, a chord bearing S63°40'49"E a distance of 18.49 feet, and an arc distance of 20.81 feet;  
 THENCE N68°37'01"E tangent with the last and following described curves a distance of 43.07 feet;  
 THENCE along the arc of a curve to the left, having a central angle of 95°32'50", a radius of 130.00 feet, a chord bearing N20°50'36"E a distance of 192.53 feet, and an arc distance of 216.79 feet;  
 THENCE N26°55'49"W tangent with the last and following described curves a distance of 80.51 feet;  
 THENCE along the arc of a curve to the right, having a central angle of 57°50'33", a radius of 190.00 feet, a chord bearing N01°59'27"E a distance of 183.77 feet, and an arc distance of 191.81 feet;  
 THENCE N30°54'44"E tangent with the last described curve a distance of 32.75 feet;  
 THENCE S59°05'16"E a distance of 125.82 feet to the **POINT OF BEGINNING ACCESS C.**

Containing 37,169 net square feet, more or less.

Containing 37,877 gross square feet, more or less.

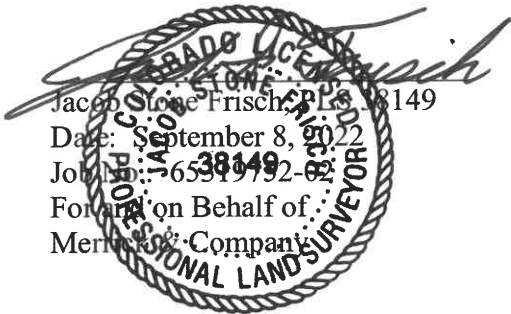

N 1/4 COR. SEC. 20, T2S, R66W  
 FND. ILLEGIBLE 3-1/4" DIA. ALUM. CAP,  
 1.0' BELOW ASPHALT ROAD IN A RANGE BOX

**POINT OF COMMENCEMENT**  
 NE COR. OF SEC. 20, T2S, R66W  
 FND. #5 REBAR WITH 3-1/4" DIA. ALUM. CAP,  
 STAMPED " 2016, PLS 37890", FLUSH WITH GRD

N89°04'32"E 2,659.36'

**ACCESS A**  
 AREA=237 SQ FT ±

**POINT OF BEGINNING ACCESS A**  
 L1

L15

C5  
 20.00'  
 C6  
 60.00'

NORTHERLY LINE PARCEL C  
 REC. NO. 2007000082031

60' WATER LINE ESMT.  
 SACWSD REC. NO.  
 20041209001252140

100' WIDE ROW PER QUIT  
 CLAIM DEED RECEPTION  
 NUMBER 20040930000973120,  
 DATED 09/30/2004

PROPOSED SEWER EASEMENT

339.33'  
 EAST  
 96TH  
 AVE.

**POINT OF BEGINNING ACCESS B**  
 L5

**ACCESS B**  
 AREA=471 SQ FT ±

30' PIPELINE ESMT. THE  
 SINCLAIR PIPELINE CO., LLC  
 REC. NO. C0435113, BOOK  
 5442 PG 33

**ACCESS C**  
 AREA=37,169 SQ FT ±

NE1/4 SEC. 20,  
 T2S, R66W

WESTERLY LINE PARCEL C  
 REC. NO. 2007000082031

L114  
 BUCKLEY RD.  
 9117 (NO DOCUMENTATION)

S00°12'07"W 2,667.13'  
 BASIS OF BEARINGS:

S02°52'17"W 711.74'

**POINT OF BEGINNING ACCESS C**  
 L9

NW1/4 SEC. 21,  
 T2S, R66W

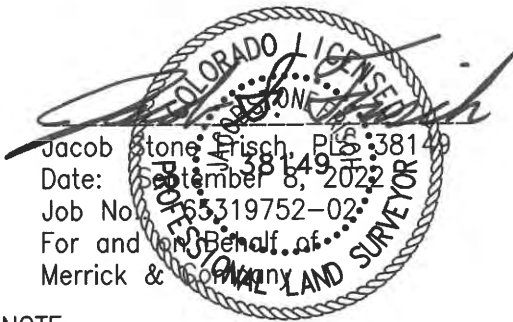
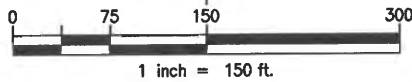

**NOTE**  
 This exhibit does not represent a monumented survey.  
 It is intended only to depict the attached description.

E 1/4 COR. OF SEC. 20, T2S, R66W  
 FND. 3-1/4" DIA. BRASS CAP, STAMPED  
 "2012, PLS 34988", 0.2' BELOW GRD

FND BENT #5 REBAR  
 WITH 1-1/4" DIA.  
 PINK PLASTIC CAP,  
 STAMPED "PLS 37890",  
 FLUSH WITH GROUND

S'LY LINE TRACT G,  
 BUFFALO HIGHLANDS,  
 FILING NO. 1

Dwg. CWS  
 Ckd. JSF  
 App. JSF



METRO WASTEWATER  
 RECLAMATION DISTRICT

**EXHIBIT B**

Parcel SDI-0229 ACCESS  
 Second Creek Interceptor

DATE:  
 9/08/2022  
 DWG. NO.  
 SDI-0229(265,292) ACCESS  
 SH 4 OF 5

**ACCESS A**

LINE TABLE		
LINE #	BEARING	LENGTH
L1	S0° 12' 07"W	9.63'
L2	S89° 49' 23"W	25.06'
L3	N0° 07' 55"E	9.31'
L4	N89° 04' 32"E	25.07'

**ACCESS B**

LINE TABLE		
LINE #	BEARING	LENGTH
L5	S0° 12' 07"W	22.49'
L6	S62° 58' 55"W	22.59'
L7	N4° 21' 53"W	21.67'
L8	N62° 58' 55"E	24.53'

**ACCESS C**

LINE TABLE		
LINE #	BEARING	LENGTH
L9	S4° 21' 53"E	24.50'
L10	N59° 05' 16"W	107.47'
L11	S26° 55' 49"E	80.51'
L12	S68° 37' 01"W	78.79'
L13	N15° 58' 38"W	477.42'
L14	N16° 48' 07"W	172.71'
L15	N89° 04' 32"E	34.64'
L16	S16° 48' 07"E	172.85'
L17	S15° 58' 38"E	441.84'
L18	N68° 37' 01"E	43.07'
L19	N26° 55' 49"W	80.51'
L20	N30° 54' 44"E	32.75'
L21	S59° 05' 16"E	125.82'

**ACCESS C**

CURVE TABLE					
CURVE #	DELTA	RADIUS	CHORD BEARING	CHORD LENGTH	LENGTH
C1	90° 00' 00"	12.50'	S75° 54' 44"W	17.68'	19.63'
C2	57° 50' 33"	170.22'	S2° 01' 57"W	164.64'	171.85'
C3	95° 32' 50"	150.00'	S20° 50' 36"W	222.15'	250.14'
C4	21° 23' 45"	975.00'	N27° 29' 59"W	361.98'	364.09'
C5	19° 15' 25"	445.00'	N47° 49' 34"W	148.86'	149.56'
C6	15° 41' 40"	465.00'	S46° 02' 42"E	126.98'	127.37'
C7	21° 23' 45"	995.00'	S27° 29' 59"E	369.41'	371.56'
C8	95° 24' 21"	12.50'	S63° 40' 49"E	18.49'	20.81'
C9	95° 32' 50"	130.00'	N20° 50' 36"E	192.53'	216.79'
C10	57° 50' 33"	190.00'	N1° 59' 27"E	183.77'	191.81'

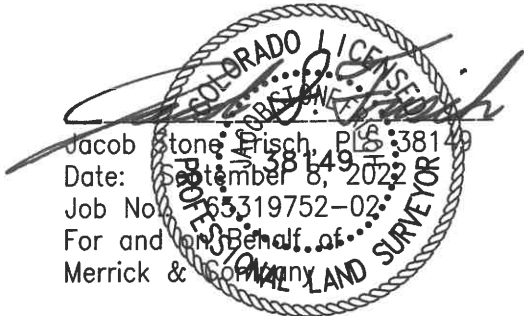
  
 Jacob Stone Frisch, PLS #38149  
 Date: September 8, 2022  
 Job No. 165319752-02  
 For and on Behalf of  
 Merrick & Company, LAND SURVEYOR

**NOTE**  
 This exhibit does not represent a monumented survey. It is intended only to depict the attached description.

Dwg. <u>ELZ</u> Ckd. <u>JSF</u> App. <u>JSF</u>	 METRO WASTEWATER RECLAMATION DISTRICT	<b>EXHIBIT B</b> Parcel SDI-0229 ACCESS Second Creek Interceptor	DATE: 9/08/2022 DWG. NO. SDI-0229(265,292) ACCESS SH 5 OF 5
---	--	--	---