

Tower Road Art Selection Committee Meeting: 5.23.18

Location: Buffalo Run Golf Course, Community Room

Time: 6:00 pm-7:00 pm

Meeting Minutes**Committee Members Present:**

Cathleen Teter, Commerce City Cultural Council

Kristi Douglas, Commerce City Cultural Council

Ed Hanson, Commerce City Cultural Council

Krystal Schumacher, Resident

Francine Crusan-Garcia, Resident

Julie Weinberg, Resident

Jessica L. Polgar, Resident

Staff: Michelle Halstead, Commerce City ; Kendall Peterson, Consultant

Meeting Notes:**Tower Road: Overview of Project**

- ❖ Group discussed the widening project, why the widening was done, the final “state” of the roadway through a Power Point presentation. The group had questions about the future zoning in the area—which is zoned to be commercial fronting neighborhoods behind. There was discussion about height restrictions on the buildings in the area and whether the artwork would eventually be right in front of a commercial strip with signage, etc.
- ❖ The group had questions about where they would place artwork (see sites below) and whether there would be artwork included in the Tower Road Ramp to Pena, which Michelle Halstead thought there would be. She was checking on the ordinance and how it coordinates with that project.

Options: Direct Purchase or Site Specific Commission

- ❖ Options were discussed for the means by which we procured the artwork. We discussed the pros and cons of each, deciding to try first to “See what is available by direct purchase” and continue to a site-specific commission if we “do not see what we are looking for.”

Budget for Artwork

- ❖ A total budget of \$160,000 has been set for the project. This will be our total budget, all inclusive of future maintenance budget contribution, Café costs, honoraria for artists, engineering and extra materials, etc.

Sites for Artwork

- ❖ The median was discussed as a possible site for the artwork and the committee discussed the possible maintenance issues with median artwork (mag chloride spray, car crashes, etc). The location was not ruled out,

as long as it was understood that the artwork would have to be long and tall and designed to withstand the elements.

- ❖ Two pedestrian pull-outs were discussed as possible sites for artwork-- along the meandering pathway. We discussed using some art budget for landscaping and berms to accentuate and protect artwork.
- ❖ The group discussed scale of artwork along the roadway. The speed limit makes the need for artwork that is of a larger scale so it will stand up to people driving past quickly. Right now, that will be the primary way the artwork is viewed—until more people begin commuting via the bike lanes or the pedestrian walkway.

Purpose of Artwork?

- ❖ The group discussed the idea of a “Welcome” marker which would announce you were in Commerce City, but there was no decision to push the artists to develop this type of project. They wanted to leave it more open-ended.

Criteria and Call to Artists

- ❖ It was agreed that the group would issue a “Call for Artwork” via Café first. The call will be to regional artists, who have artwork available of the scale and materials we are seeking.
- ❖ Scale: the artwork must be large enough to be visible in a large prairie scale. Suggested scale would be over 10 feet high, and taller than cars. Landscaping may be necessary to make the sculptures more visible to travelers on the road.
- ❖ Materials: the group is interested in robust, natural materials such as steel, stone, and concrete. The group is not interested in seeing work that will not function well in this outdoor setting (no glass, ceramic or delicate materials).
- ❖ The group is interested in artwork that will soothe, calm and bring joy and happiness to the commuters on the road. There is an interest in artwork that will be approachable to people of all ages.
- ❖ The artwork should be evocative of natural history, such as the native plants and trees in the area. No more bison or eagles.
- ❖ Unless solar lighting is considered, the artwork will not be lit for nighttime.
- ❖ Artwork that will strengthen the connection between Commerce City and the region is desired.
- ❖ If the group does not see artwork that satisfies the needs for the area in terms of scale and materials and artistry, they will return to the option of commissioning a site-specific artwork
- ❖ The group also recognized that there was a possibility of “liking an artist” who has applied with artwork that isn’t quite right. They have the right to commission a new piece from an artist they like, should they choose to.

Next Steps and Schedule

- ❖ **A new meeting was set for July 6, 2018 at 6:00pm. The location is likely to be the Bison Ridge Recreation Center.**
- ❖ **Kendall will create a Request for Artwork to be circulated to the Committee Members by next week.**
- ❖ **Call for Artwork will be posted on CAFÉ for a few weeks; Selection meeting to pre-score entries the week before the next meeting TBD.**



REQUEST FOR AVAILABLE SCULPTURE

The City of Commerce City and the Commerce City Cultural Council are seeking to purchase sculpture(s) from Colorado artists, or artists who reside in Colorado Region (determined to be Colorado and neighboring states of Wyoming Nebraska, Kansas, Oklahoma, New Mexico, Utah and Arizona). The artwork is for possible placement along Tower Road, in Commerce City, CO.

DEADLINE FOR SUBMITTAL: Friday, June 29, 2018 11:59 p.m. MST
SUBMITTALS ACCEPTED ONLINE ONLY: www.callforentry.org
TOTAL ART BUDGET: up to \$135,000 for multiple sculptures

PROJECT SUMMARY

The City of Commerce City and the Commerce City Cultural Council seek to purchase sculpture for Tower Road, a prominent roadway in Commerce City. Tower Road is a prominent arterial from between Denver and Commerce City and the street was widened between 81st to 104th and re-opened in 2016. A multimodal path, a raised median and a dedicated bike lane were added during construction, to make the road safer and better suited to handle the expected traffic in the area as it develops. The road is also a main access to the new commuter rail station at 61st and Pena, for people commuting to Denver and all points on the light rail system or who work at Denver International Airport. In this way, Tower Road serves as one of the gateways to Commerce City.

Sites are not specified yet, but artwork should be of the size, scale and materials to be sited along a roadway, in a median or alongside a multiuse path. At present, the area is undeveloped prairie land, but increasingly, the area will fill in as Commerce City continues to grow.

The road improvements were funded by the voter-approved capital improvement program.

PUBLIC ART BUDGET: up to \$135,000 for multiple sculptures

The budget for each site shall be inclusive of all costs associated with the public art project including, but not limited to: delivery of artwork to the site, installation. The artist is expected to work with the City to determine the specifications for a concrete footer, to be engineered and built by the City.

MAINTENANCE AND DURABILITY

All applicants are expected to consider the issues of long-term preservation and maintenance of public art, along with the timeline and budget. Public art projects are in the public realm and may therefore be exposed to weather and subject to vandalism. Public art projects should be fabricated of highly durable, robust, low maintenance materials. Semi-finalists will be encouraged to consult with a professional conservator prior to the submission of a final proposal.

It is strongly recommended that the artwork be tall (at least 5 feet) and larger-scale to be able



to “stand out” in this area. It is strongly suggested that the sculptures be constructed of materials that can stand up to snow, spray from the roadway (salt and other de-icing chemicals) as well as the scale of the area (now it is very open prairie land, but in coming years, it will evolve into homes, shops and a commercial zone). Acceptable materials: steel (stainless or Corten) and other strong metals, cast metals, stone, wood. Unacceptable materials: glass, ceramic, mosaic and other fragile artwork.

THEMES/CRITERIA

The art selection committee for Tower Road seeks artwork that is evocative of the natural history of the area, evokes joy and delight and has a pleasing and calming effect on the commuters who see it. It should be appropriate for all ages to enjoy.

ELIGIBILITY

The eligible applicants for this project are artists who reside in Colorado, or artists who reside in Colorado Region (determined to be Colorado and neighboring states of Wyoming Nebraska, Kansas, Oklahoma, New Mexico, Utah and Arizona). The City and Cultural Council will comply with all federal, state and local anti-discrimination laws in the administration and implementation of the public art master plan.

SELECTION PROCESS AND SCHEDULE

The Art Selection Committee will review only completed applications. A short list of semi-finalists may be created and further negotiations may take place by phone and/or email. It is possible that the Selection Committee may recommend a direct commission (rather than a direct purchase of existing art) based on the artist’s submission.

The tentative schedule is as follows:

Friday, June 29, 2018 11:59 p.m. MST

Week of July 9th, 2018

August 2018

September 2018

September/October 2018

Fall 2018

Deadline for Submissions

Notify semi-finalists

Cultural Council review

City Council review

Execute purchase contract

Installation

APPLICATION PROCESS

All applications for this project must be submitted through CaFÉ™ (www.callforentry.org) no later than the deadline for submission identified above. No hard copy or e-mail submissions will be accepted. There is no application fee to apply or to use the CaFÉ™ online application system.

The applicant must submit the following:

1. **Digital Images.** A maximum of five digital images of sculpture available for purchase through the CaFÉ™ system. Please include sculpture materials, dimensions and cost for each work of art.



Instructions on how to use CaFÉ™ and format images/video can be found at www.callforentry.org/image_prep.phtml. Assistance in using the CaFÉ™ system is available during regular business hours by calling 303-629-1166, 1-888-562-7232 or e-mail cafe@westaf.org.

2. **Résumé:** A current résumé that outlines your professional accomplishments as an artist. Your resume may be any length, but the committee members are only required to read to the first two pages. If applying as a team, please submit a resume for each artist, with the lead artist first.
3. **Response to questions:** Please also include answers to the following questions in the CaFÉ™ application.
 - ❖ Are you an artist who resides in Colorado, or resides in Colorado Region (neighboring states of Wyoming Nebraska, Kansas, Oklahoma, New Mexico, Utah and Arizona)?



ABOUT COMMERCE CITY, COLORADO

As the state's third-fastest growing city, Commerce City is redefining itself for the next generation, building on historic values of community, industry, agriculture and family. Centrally located along Colorado's bustling Front Range, Commerce City is a *Quality Community for a Lifetime*, with 25 miles of trails, a championship golf course, 840 acres of open space and parks, one of the country's largest soccer complexes and the nation's largest urban wildlife refuge.

Learn more at www.c3gov.com.

ABOUT THE COMMERCE CITY PUBLIC ART PROGRAM

The goal of the Commerce City Public Art Program is to acquire public art unique to Commerce City that reflects community values, and to place it within public spaces for the community and visitors to enjoy. This public art will generate community pride and contribute to the vitality of the community by enhancing quality of life. Also, public art may remind us of our heritage, serve as a source of celebration, and prompt new ways of seeing and inspiring conversation and reflection. Completed in 2013, the Public Art Master Plan provides a framework to guide the Commerce City Cultural Council in selecting the most appropriate public artwork that reflects the community's values and culture for designated locations throughout Commerce City.

LEGAL COMMENTS

Commerce City and the Commerce City Cultural Council reserve the right to reject any or all applications, proposals, applicants, and projects, to waive any informalities or irregularities, and to modify or terminate the application process or the selection process for any reason and without prior notice. The issuance of this Request for Qualifications and the receipt and evaluation of applications do not obligate Commerce City to select any proposal or applicant or enter into any agreement. The City will not pay any costs incurred in responding to this Request for Qualifications except as expressly stated.

Applicants are cautioned not to undertake any activities or actions to promote or advertise their submittal, other than discussions with City staff as described. Proposers are not permitted to make any direct or indirect contact with members of the Art Selection Committee, the Commerce City Cultural Council, the City Council, or media on the subject of this Request for Qualifications, except in the course of City-sponsored presentations or to submit questions. Violation of these rules is grounds for disqualification.

QUESTIONS

Questions regarding this Request for Qualifications must be submitted by e-mail only to Deana Miller, Public Art Consultant, at deana@artmanageplan.com, **no later than 5:00 p.m. MST, Monday, October 12, 2016**. Responses to all questions will be posted on the City's website and CaFE™.



City of Commerce City
Public Art Program



ADDITIONAL SOURCES OF INFORMATION

<https://www.c3gov.com/index.aspx?nid=285>

<https://www.c3gov.com/index.aspx?nid=287>

<https://www.c3gov.com/index.aspx?NID=383>



Tower Road Art Selection Committee Meeting **September 17, 2018**

Location: Bison Ridge Recreation Center

Time: 6:00 pm 8:00 pm

Committee Members Present:

Cathleen Teter, Commerce City Cultural Council

Kristi Douglas, Commerce City Cultural Council

Ed Hanson, Commerce City Cultural Council

Francine Crusan-Garcia, Resident

Julie Weinberg, Resident

Krystal Schumacher, Resident

Jessica L. Polgar, Resident

Staff: Daniela Villarreal, Commerce City ; Kendall Peterson, Consultant

Meeting Notes:

- ❖ After the last meeting, a call for artists went out. The request for artwork called for regional artists to apply, with a budget of up to \$135,000 for multiple sculptures (all-inclusive), and requested for artwork to be evocative of the natural history of the area.
- ❖ Forty-nine total artists submitted to be considered.
- ❖ The purpose of this meeting will be to go through all submissions and narrow down to five artists to be invited to come in and do a formal, site-specific, proposal to the committee.

Outcome:

- ❖ By a unanimous decision, the following will be invited to come in and do a proposal: Kevin Shaffer, Stephen Shachtman, Wayne Salge, Steve Southerland, and Mark Horst.

Next Steps and Schedule

- ❖ Kendall will reach out to artists, and schedule a date that works best for everyone to come in and do a proposal.



Tower Road Art Selection Committee Meeting **January 26, 2019**

Location: Civic Center Room #2108

Time: 9 a.m. - 2:00 pm

Committee Members Present:

Kristi Douglas, Commerce City Cultural Council

Ed Hanson, Commerce City Cultural Council

Francine Crusan-Garcia, Resident

Krystal Schumacher, Resident

Julie Weinberg, Resident

Jessica L. Polgar, Resident

Staff: Daniela Villarreal, Commerce City ; Kendall Peterson, Consultant

Absent: Cathleen Teter, Commerce City Cultural Council

Meeting Agenda:

- ❖ 9 a.m. Arrival of Selection Committee Members; review project criteria, etc.
- ❖ 9:30 a.m. Keven Shaffer Presentation
- ❖ 10:15 a.m. Stephen Shachtman Presentation
- ❖ 11 a.m. Wayne Salge Presentation
- ❖ 11:45 a.m. Break/Lunch
- ❖ 12:15 p.m. Steve Southerland Presentation
- ❖ 1 p.m Mark Horst Presentation
- ❖ 1:45 p.m. Committee Members Debrief and decision making

Presentations Summary:

- ❖ Kevin Shaffer, Leadville, CO selected three types of sculpture forms based on parts of natural grasses: Sprouts, Stems and Leaves. A total of 38 Corten steel sculptures would be placed in all the 9 medians from 81st to 104th.
- ❖ Stephen Schachtman, Fort Collins, CO proposed three large (26') towers of Corten steel to be placed in medians at 81st 96th and 104th. There were different options for color and variations at the tops of the towers.
- ❖ Wayne Salge, Loveland, CO proposed three contemporary figural bronzes on pedestals. The collection, called "The Visionaries" would three 8' high figures, titled: "Seriously" "Step Up" and "Really."
- ❖ Steve Southerland, Norman, OK proposed three sculptures to be placed at 104th, 96th and 81st. They were all between 7'-10" and constructed of mild steel and painted. They were a Feather, a Guitar and a Dream Catcher.
- ❖ Mark Horst, Albuquerque, NM proposed three colorful stylized leaves/grass sculptural installations based on native plants in the region. The three installations are based on a Milkweed Leaf, Grama Grass and a Cottonwood Leaf. They would be constructed of laser-cut steel or aluminum and painted with marine grade paint.



Tower Road Art Selection Committee Meeting **January 26, 2019**

Committee Discussion:

- ❖ Kevin Shaffer, Leadville, CO
PROS: great connection to site, a lot of artwork for the money, terrific presentation (very thoughtful).
CONS: will take 16 months to install, "Sprout" was a bit heavy.
- ❖ Stephen Schactman, Fort Collins, CO
PROS: terrific scale for the road, color was nice.
CONS: too "contemporary."
- ❖ Wayne Salge, Loveland, CO
PROS: "makes me smile," sculptures could be your "buddies" as you commute, optimistic.
CONS: preferred the sculptures grouped together.
- ❖ Steve Southerland, Norman, OK
PROS: whimsical, liked the feather.
CONS: not a terrific connection to site, engineering concerns.
- ❖ Mark Horst, Albuquerque, NM
PROS: terrific scale for the road, amazing drive-by effect, colors were nice, sculpture will "help sell the community," a feeling that these would help brighten the area and give a feeling of optimism.
CONS: slight concern that sculptor is from Albuquerque (but all fabrication will be done in COMMERCE CITY, which is a PRO.)

Results:

- ❖ The Selection Committee unanimously ranked the proposals:
1st Mark Horst, 2nd Kevin Shaffer, 3rd Wayne Salge.

Next Steps and Schedule

- ❖ **Proposal will be presented to Cultural Council February 12, 2019 then to City Council March 18, 2019 for final approval.**
- ❖ **Upon approval, staff will execute artists contract.**



Commerce City Cultural Council February 12, 2019 Meeting Minutes

Call to Order/ Roll Call

Present: Kristin Henning, Jacob Wilson, Ed Hanson, Gary Kidd, Councilmember Guardiola, Councilmember Elliott, Kristi Douglas

Absent: Lucy Molina, Abe Ramirez, Angela Ramirez, Debra Bullock, Cathleen Teter

Welcome/Guest and New Member Introductions

Next round of interviews will take place in April.

Regular Business Items

- Approve January 8, 2019 Meeting Minutes
Hanson moved to approve. Kidd seconds. Motion was approved
- Financial Updates
No update for the month
- New members or applications
No updates
- Complete outside hours document
Document passed around
- Food for next meeting-see calendar
Staff will check document
- Record numbers at all events
Deb will create a form to keep track of attendance at events for reporting purposes.

Committee Reports and Discussion

- Public Art/Others
 - Rotating Art Exhibit Update
Deb proposes that Cultural Council and CCHS host next exhibit with Commerce City landmarks. Members agreed that a before and after element should be incorporated into the exhibition. Historical society to provide old pictures and put a call for artist for current pictures.
 - Tower Road Art Selection Presentation by Kendall Peterson
Kidd motioned to approve proposed artwork for the site. Hanson seconded. Motion approved unanimously.
 - Art Wrap-Leadership Commerce City-Cultural Council
Bullock proposes a \$500.00 partnership. Discussion will be tabled for March.
 - Public Art Committee Fronterra
First meeting to start at end of February. Cultural Council representatives will be Debra Bullock and Kristin Henning.
 - District Art Show Adams 14
Bullock is in contact with Adams 14 district and Henning will ask 27 J about student art show

- Care and Maintenance recommendations for public art

Henning shared some concerns on the lack of progress for public art maintenance. Henning also added that there are some items on the Public Art Master Plan she would like to see some action on. Henning will provide detailed material to both councilmembers and Cultural Council and staff for further review.

- Music in the Park
 - Band contracts have been completed.
 - Food Trucks
No update
 - Rain Out Date will be August 15
- Fundraising 101 will be postponed for March.
- QCF Grant report and grant completed and submitted
- SCFD grant report has been submitted. Staff and members will work on application.
- Commerce City Eats update (see attachment)
 - Committee: Kristin, Jose, and Abe
- Marketing Materials needs: new tent, box for supplies, t-shirts.
Tabled for next month
- Social Media Joel
No update
- Calendar for 2020 status
No update
- Sponsorships
Will be touched on during the Fundraising 101 presentation.

New Business – Miscellaneous Items and Open Discussion

- New possible events to keep in mind:
 - Movie in the Park
 - Memorial Day Parade Celebration Band
 - Taste of Commerce City-Art in the Derby
 - Colorado Symphony
 - July 4 Celebration Band
 - Adult Art Show and reception
 - Murals

Member Comments/Announcements

None

Meeting Adjourned

Next meeting: March 12, 2019

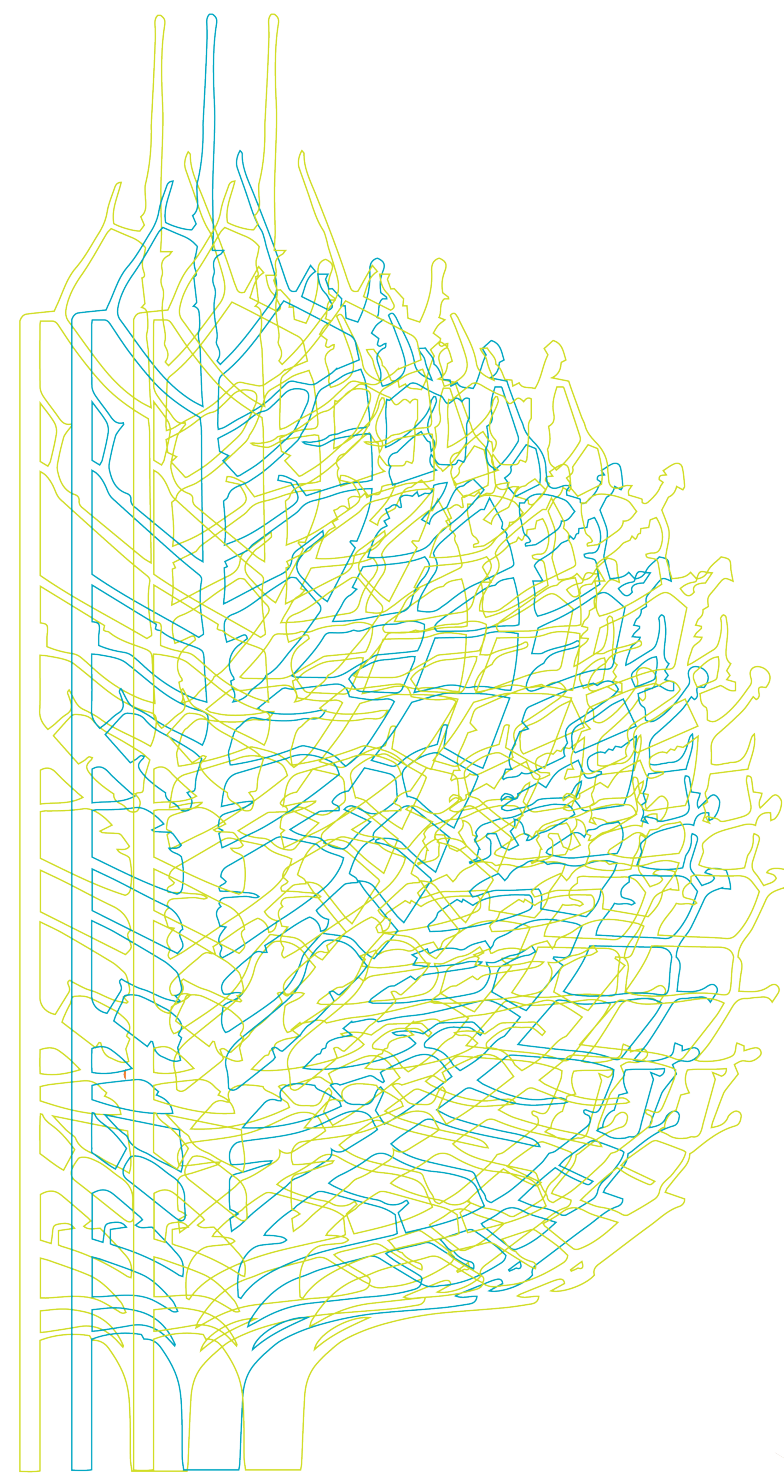

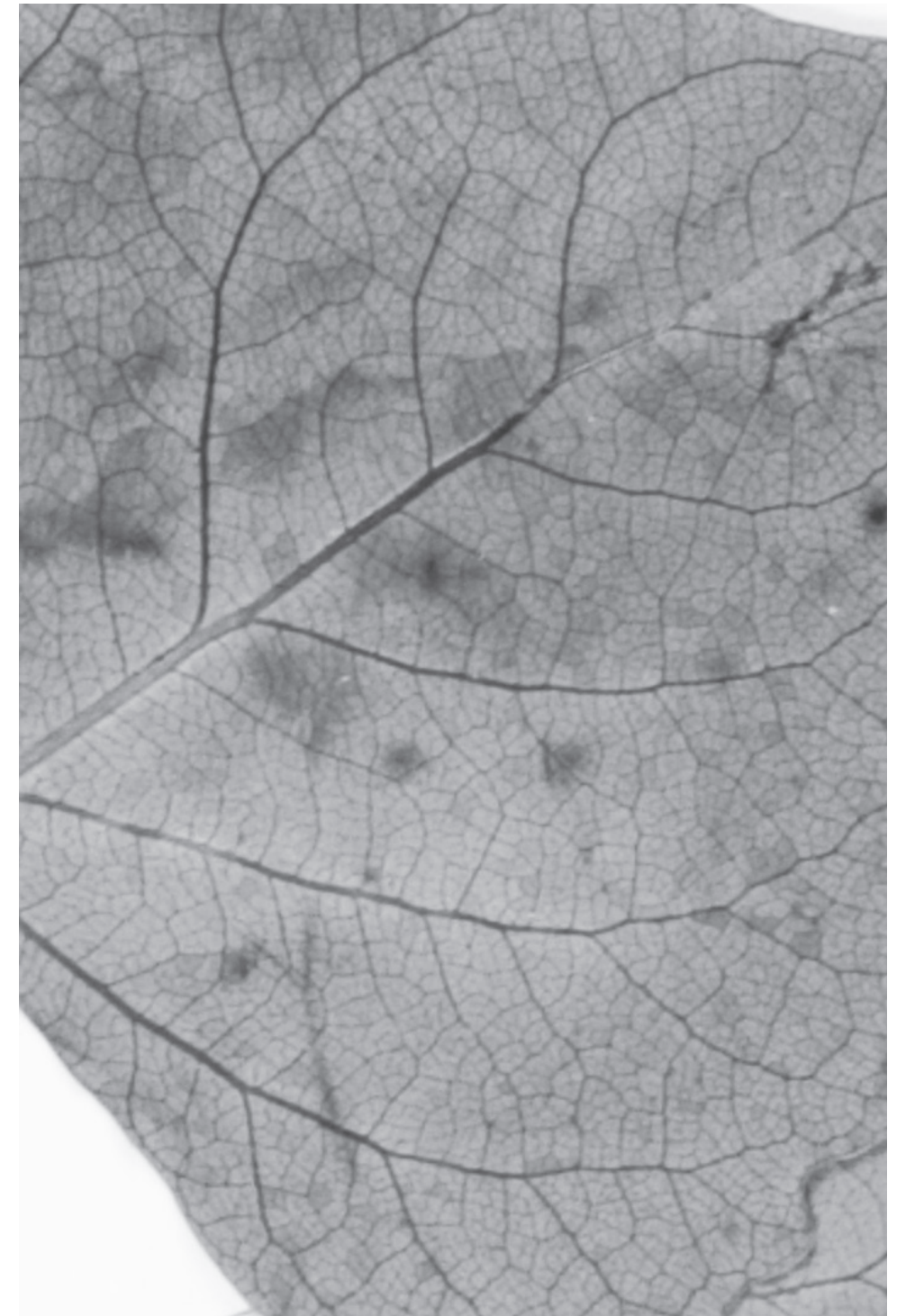

a word about my intentions

the world is beautiful and mysterious

the deep structures of the natural order are hidden

what happens when we take the veins of a leaf or the habit of blossoming grass and make them visible?

the subtle, hidden thing is seen, even as we rush around in our fast cars...

what happens when we take these delicate shapes and layer them

so that their lacy, lattice work comes alive as the light strikes their edges

so that they shift and recede in space as we move around and through them

why these images in this place?
native colorado species... common to parks and wildlife preserves...
highlighted in Rocky Mountain Arsenal... Second Creek Open Space...

image progression: milkweed example...



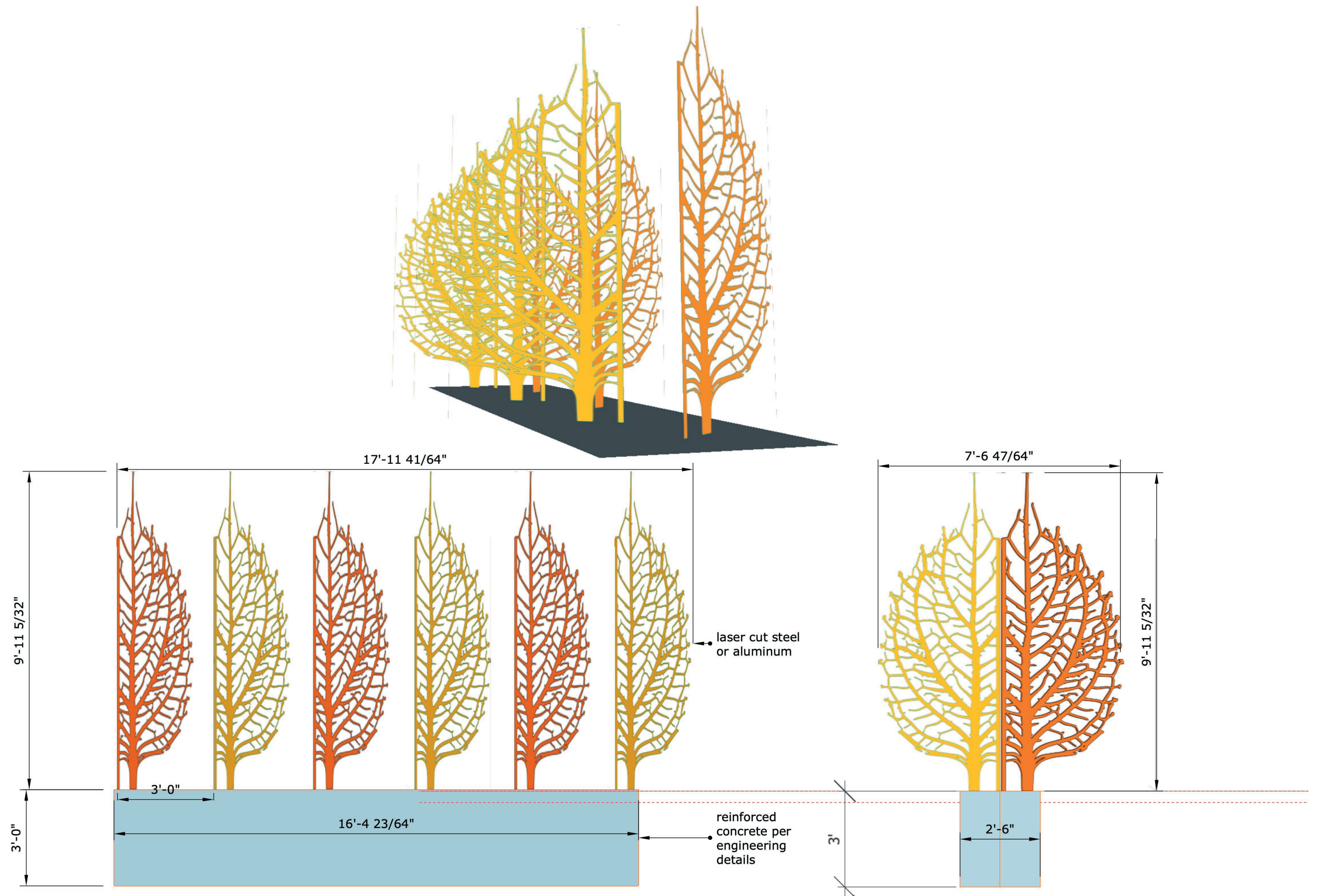

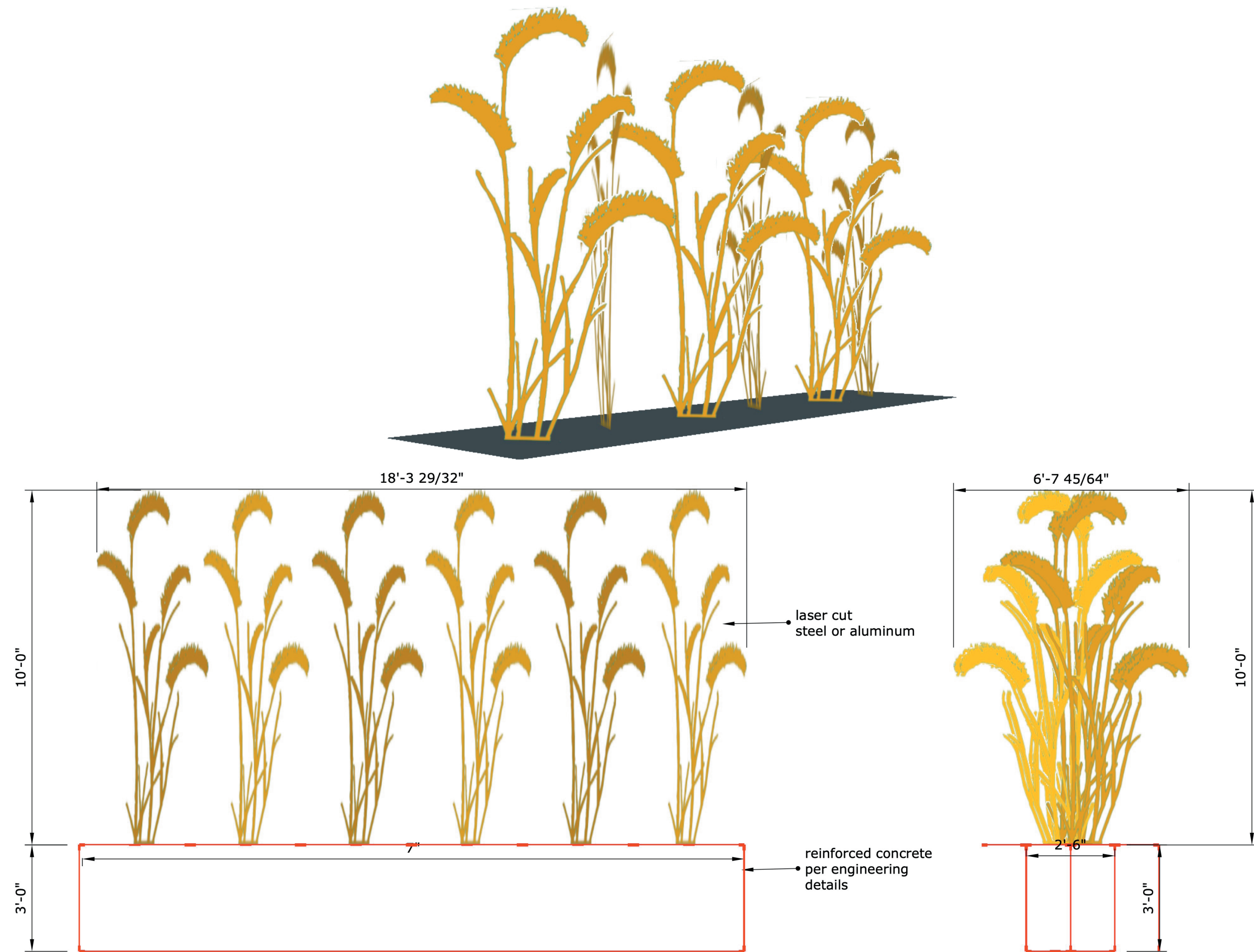

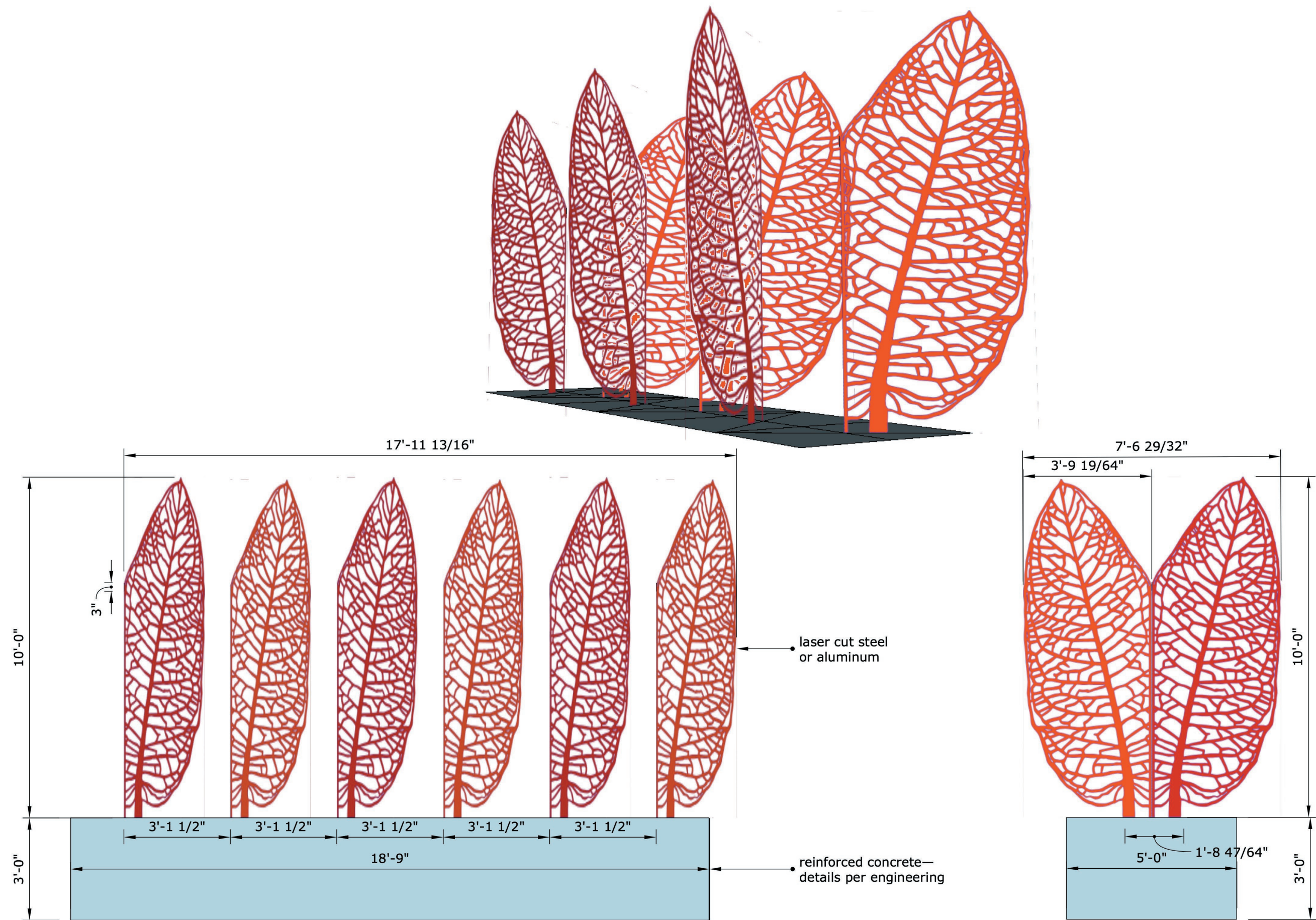

	10' profile 1/2" Mild Steel	10' profile 1/2" Corten	10' Profile 1/2" Aluminum	10' Profile 3/8" Aluminum
6 pieces Cottonwood Leaf	7,956	10,844	13,432	9,867
6 pieces Milkwood Leaf	8,704	11,592	14,932	11,042
6 pieces Blue Gama Grass	7,956	10,844	18,832	13,836
Material & Cutting Subtotal	24,616	33,280	47,197	34,745
Base plates & Fabrication	15,000	15,000	15,000	15,000
Engineering (allowance)	3,000	3,000	3,000	3,000
Wet Paint/powder coat (allowance)	15,000	8,000	8,000	8,000
Concrete (allowance)	20,000	20,000	20,000	20,000
Installation estimate including shipping, equipment rental & traffic management	15,000	15,000	15,000	15,000
Artist design Fees	15,000	15,000	15,000	15,000
Photography & Documentation	1,000	1,000	1,000	1,000
Travel	2,000	2,000	2,000	2,000
Contingency	10,000	10,000	10,000	10,000
Total	120,616	122,280	136,197	123,745

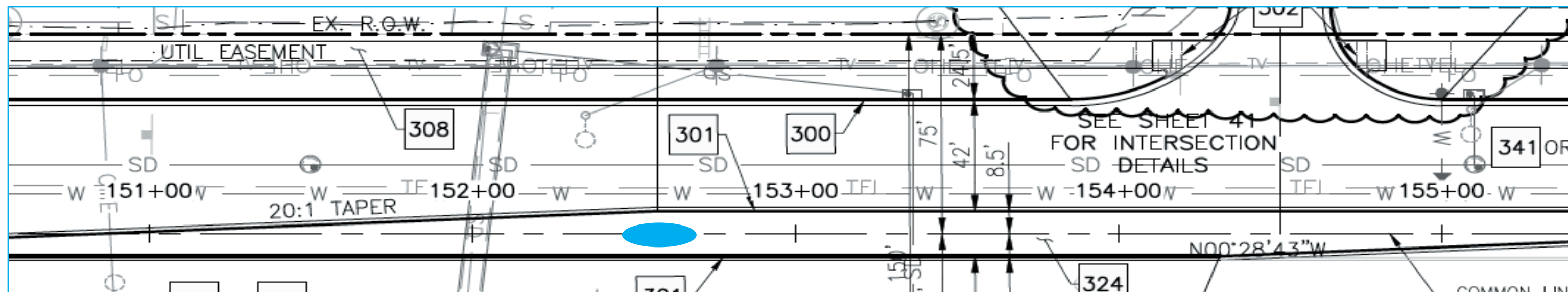

LOCATION #1 (NORTH OF 81ST ST.--COTTON WOOD LEAF SCULPTURE

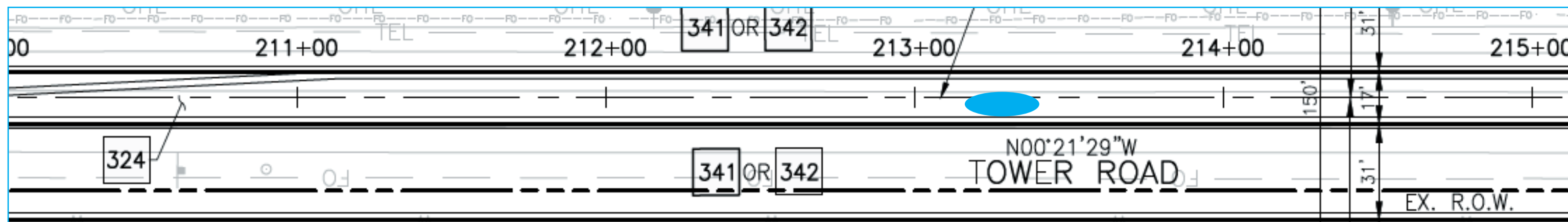

LOCATION #2 (@ 88TH OR 94TH ST)--BLUE GRAMA SCULPTURE

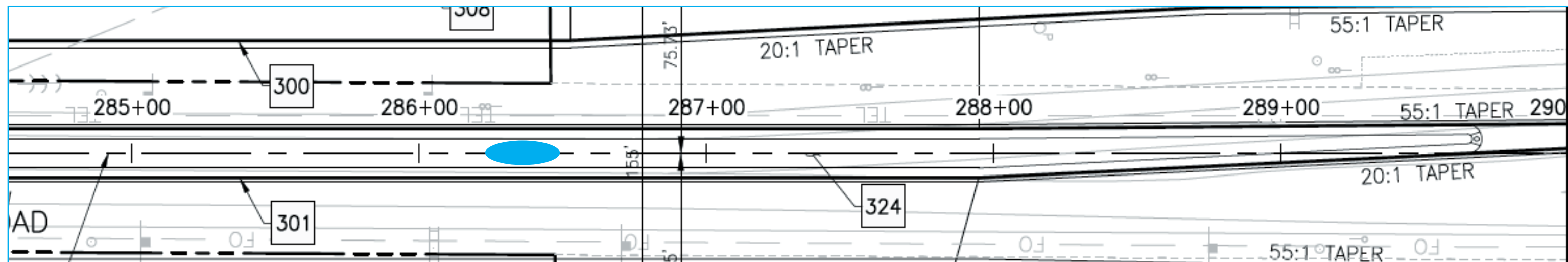

LOCATION #3 (SOUTH OF 104TH ST.)--MILKWEED LEAF SCULPTURE