



# Bison Ridge

---

Tech Room Transformation | Active Adult Center

# PRESENTATION OUTLINE:

---

- Transformation Overview
- Project Goal
- Project Roadmap
- Design Considerations
- Design Concept Review
- Public Engagement Results
- Next Steps
- Questions



# TRANSFORMATION OVERVIEW:

---

## TECH ROOM TO SERVICE AS AN ACTIVE ADULT CENTER:

Monday – Friday from 8 a.m. to 4 p.m.

Active Adult programs are focused on seniors and older adults, but is ultimately open to all adults 18+

General public use all other hours



# PROJECT GOAL:

---

Develop a room layout incorporating new furniture to optimize space for community members, participating in a wide-range of diverse programming opportunities.



# PROJECT ROADMAP | OVERVIEW:

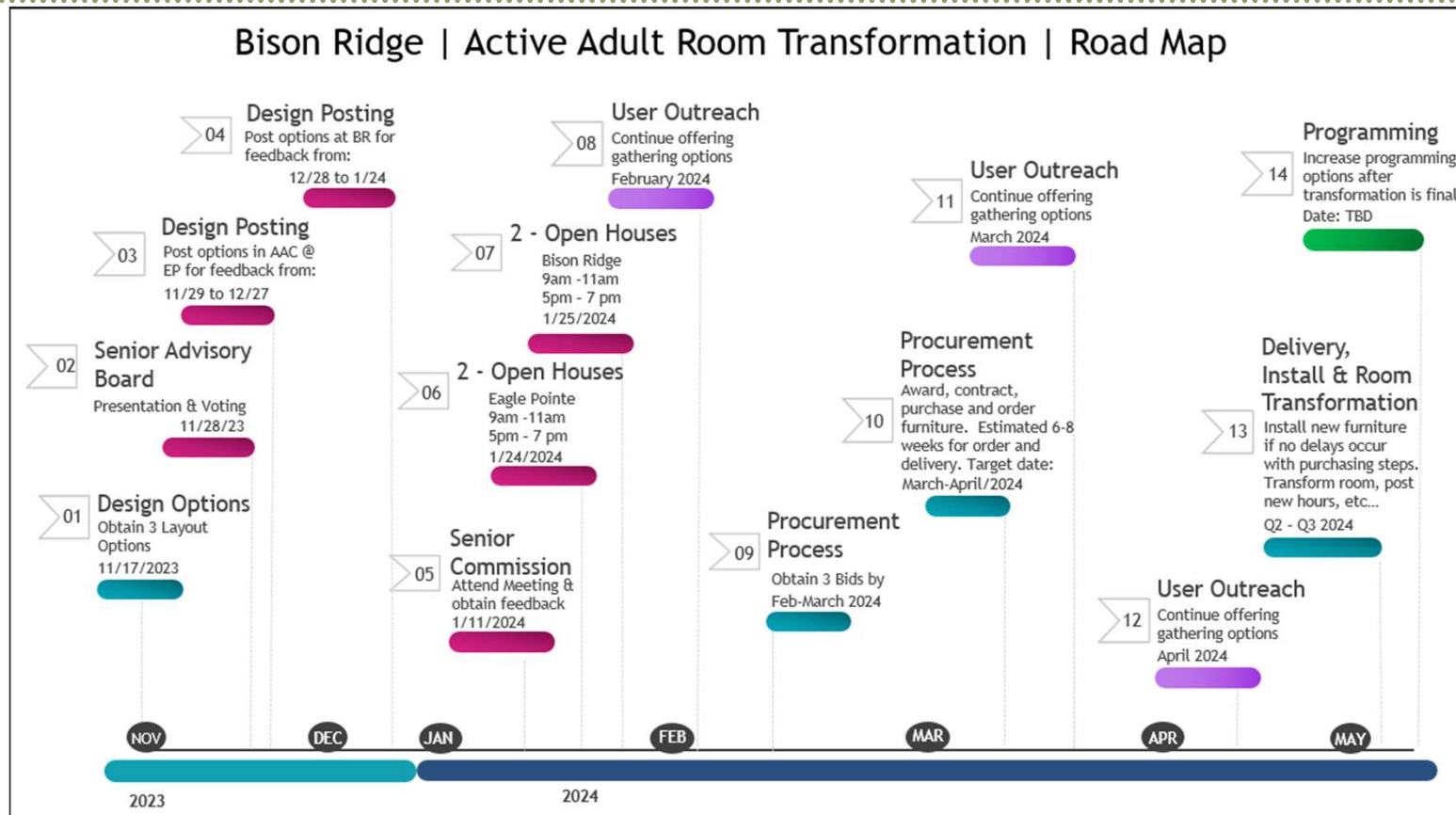

# THINGS WE CONSIDERED:

---

**1. Many seniors and older adults may be experiencing increasing difficulties with strength and mobility:**

- o Seating free of wheels
- o Wider seats with arm-rests to provide a sturdy grip to raise and lower oneself onto the seat
- o Seating that is cushioned, durable and easily cleaned
- o Chairs that are strong, but also lightweight

**2. The space will be utilized by other programs as well:**

- o Multiple types of Active Adult programs
- o Meetings (PRG Advisory Meeting)
- o Programs
  - \* flexibility with furniture mobility is important
  - \* furniture that can be easily reconfigured

**4. Selecting furniture with the most suitable characteristics.**

**5. Color and fabric style selections will occur once the ideal furniture pieces are determined.**

**6. Engagement regarding what type of programming community members would like to see take place in the space.**



# 3 DESIGN CONCEPTS FOR PUBLIC ENGAGEMENT:

Option #1:

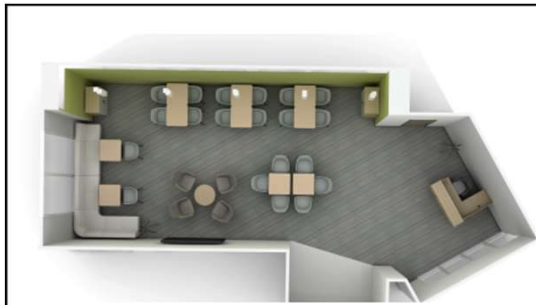

- 9 to 5 Lilly guest chair (16)
- 9 to 5 Lilly Lounge (4)
- Steelcase Simple table with square case (10)
- Global River Sectional (1)
- Global Zira reception desk
- Zira Storage piece with glass door (laminated doors are available)
- Steelcase Series 1 task chair with mesh back.



Option #2:



- OFS Cinque guest chair (12)
- OFS Heya booth with table (3)
- 60W OFS Waste/bin storage credenza
- Elara sofa (1)
- Elara lounge chair (2)
- Strap side table (1)
- Nineteen20 table (6)
- Elements reception desk
- Steelcase Series 1 task chair with mesh back
- Blu dot coat rack



Option #3:

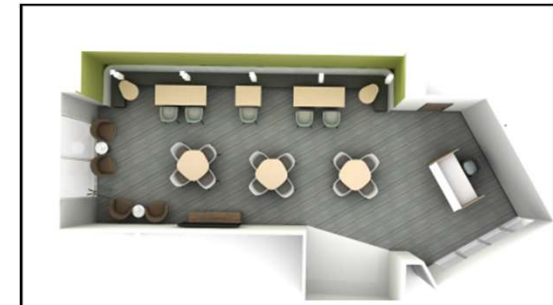

- 9 to 5 Lilly guest chair (17)
- Orange box - modular lounge
- Elbrook 30x36 tables (5)
- Elbrook Organic table (3)
- 72W Currency storage credenza
- WestElm - Wrap lounge chair (4)
- West Elm Maisie side table (2)
- Steelcase reception desk
- Steelcase Series 1 task chair with mesh back
- Blu dot coat rack



# PUBLIC ENGAGEMENT OUTREACHES:

---

## 1. PRG Senior Advisory Committee:

- 11/28/2024

## 2. Senior Commission Presentation:

- 1/11/2024

## 3. General Open Public Voting:

- Eagle Pointe Recreation Center:  
11/29/2023 to 12/27/2023
- Bison Ridge Recreation Center:  
12/28/2023 to 1/24/2024

## 4. Four Open Houses:

- Eagle Pointe Recreation Center:  
1/24/2024 – 9 a.m. to 11 a.m.  
1/24/2024 – 5 p.m. to 7 p.m.
- Bison Ridge Recreation Center:  
1/25/2024 – 9 a.m. to 11 a.m.  
1/25/2024 – 5 p.m. to 7 p.m.





# PUBLIC ENGAGEMENT RESULTS:

## Combination of Option #1 & Option #2:

- Flexibility with furniture mobility
- Option 1 individual tables, no low seating
- Option 2 individual chairs, no benches
- Option 2 ADA accessible reception desk
- Change out hanging lights
- Add bookcases and storage units

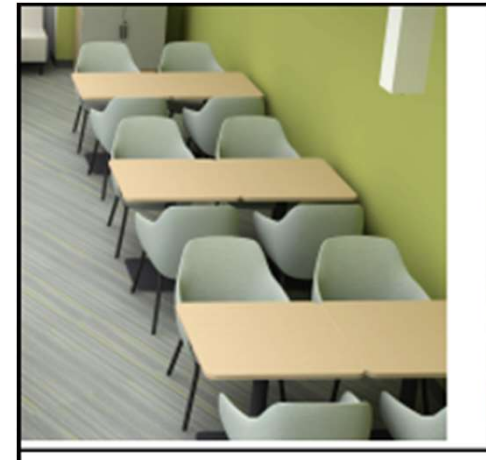

# PROJECT ROADMAP | NEXT STEPS:

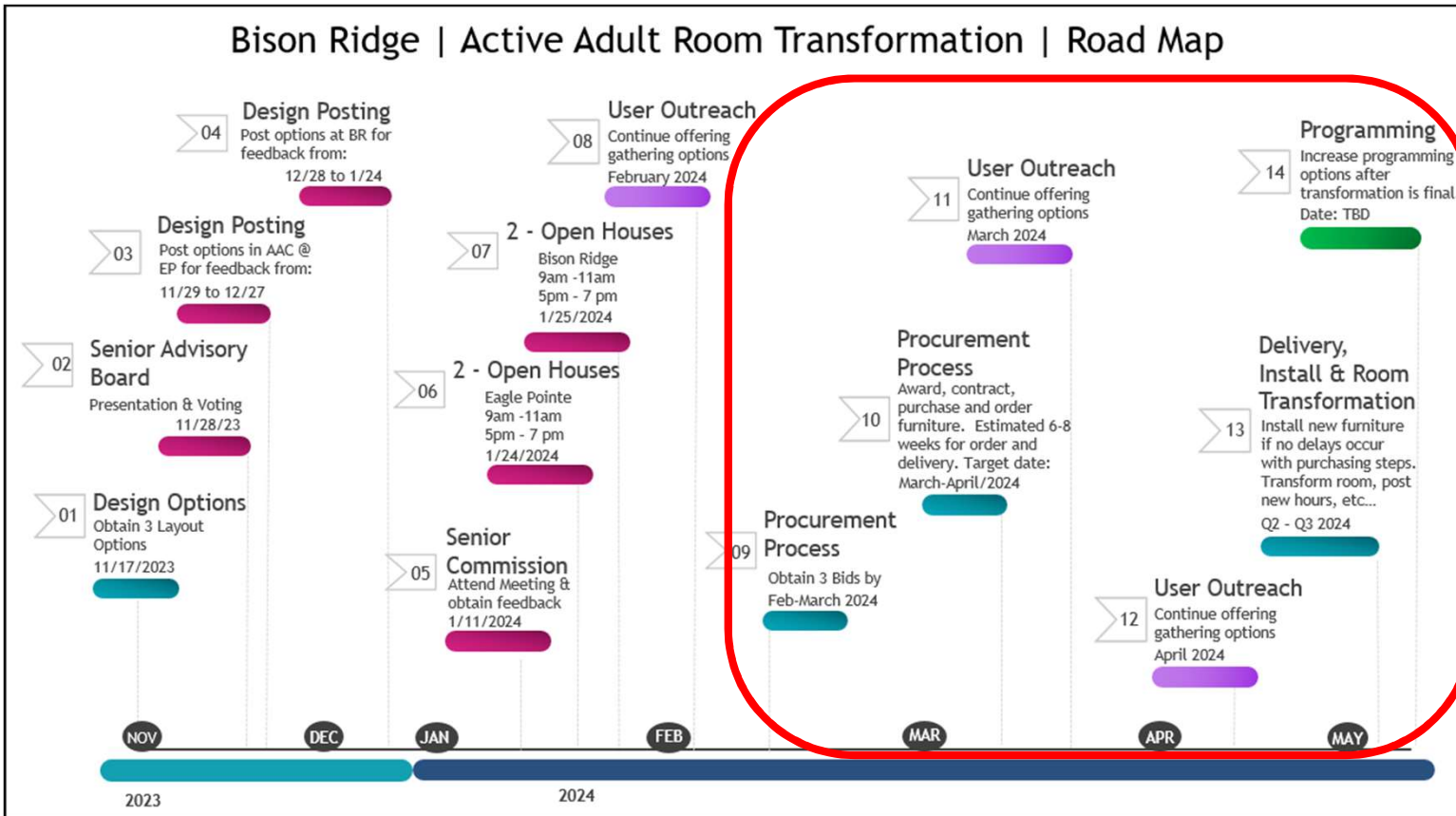

# QUESTIONS?

---

